

# Index

	Page
General Technical Notes	3
System Technology, Measurements	4-5
Components	6-12
Wall System	13-16
Spider Fixing Techniques	17-18
Double Deck Constructions:	19-27
Spaceframe	19-21
Load Bearing Girder	22-27
Framegirder	28-29
Cable Technique	30-31
Central Fixture	32-34
Accessories/Tools	35

## General Technical Notes:

**This Component Catalog 'System and Function' is intended for specialist users who are familiar with engineering principles, the relevant standards and safety regulations and, in particular, with the guidelines and regulations of fair and exhibition construction.**

Besides compliance with requirements for the construction (as set out by the relevant supervisory authorities, and with the technical requirements), an essential precondition for the erection of a multi-story stand is provision of approved structural calculations. Also skilled staff, relevant assembly tools and construction aids are required.

For multi-story stands built from the 4D load bearing girder an approved structural calculation is available from MERO.

When using 4D Spider Fixings for securing glass cladding, certificates and structural calculations are available. These are often required when the wall and cladding need to comply with 'drop prevention' requirements. Please contact our Technical Department for further details.

---

4D System  
System and Function  
Publication for planners and users of MERO Exhibit Systems.

Re-printed by MeroForm Systems USA, with express permission of MERO GmbH & Co. KG, Exhibit Systems.

Edition 2003. All rights, including those of reprints in whole or in part, of photo mechanical reproduction and other copies, require written permission.

© MERO GmbH & Co. KG Exhibit Systems

We reserve the right to modify construction, materials and dimensions. We assume no liability for values and measurements given in this publication, particularly in illustrations, drawings, plans, calculations, and tables, unless they have been explicitly declared binding in writing.

# System Technology, Grid Dimensions

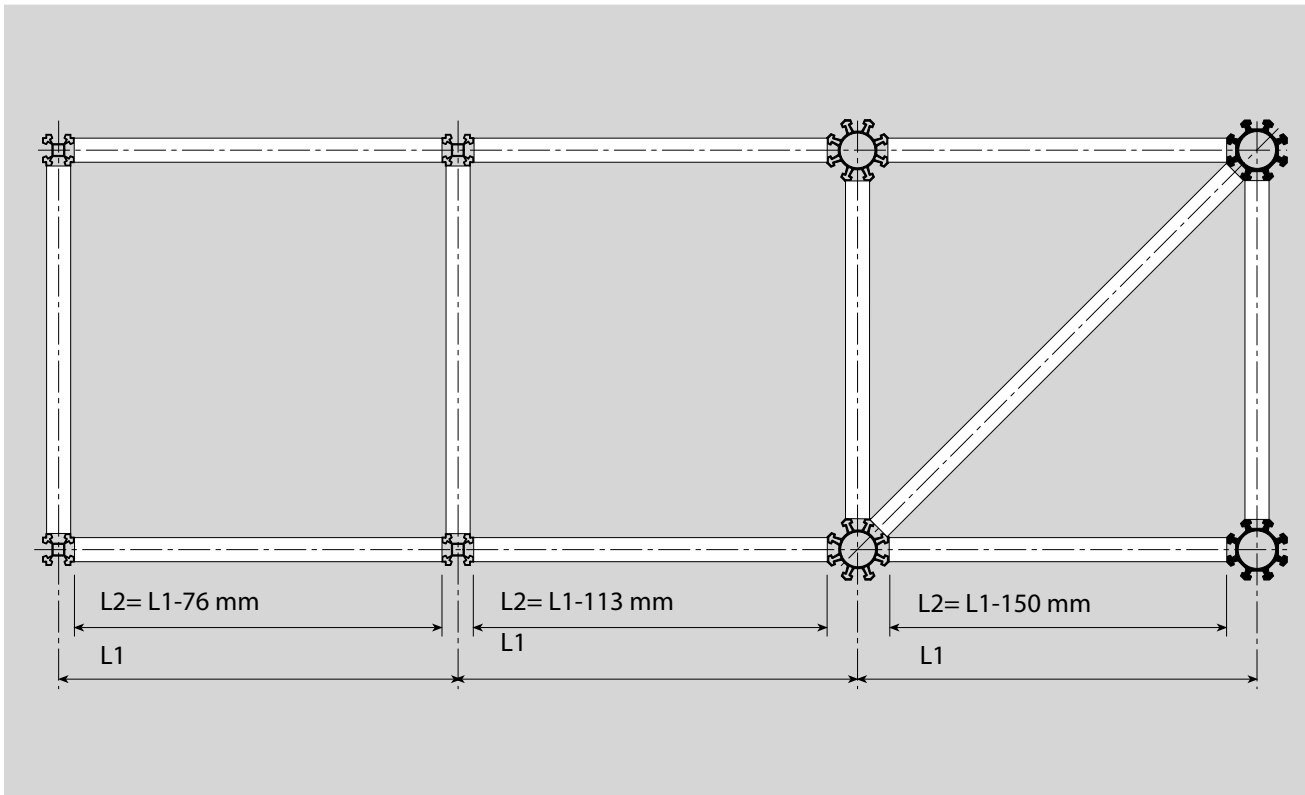

## Lengths of the Grid Rods

The grid dimensions of the 4D Construction System are given by the system measurement L1 and are measured from node axis (support axis) to node axis.

## The tube length

L2 depends on the dimension of the node cross-section/support cross-section. If octagonal or square support profiles are used, the tube length L2 changes in accordance with the difference in the profile dimensions.

## Description of the Grid Rods:

e.g. Tube 1000/887 mm 60 x 4 L K 4/8 AL

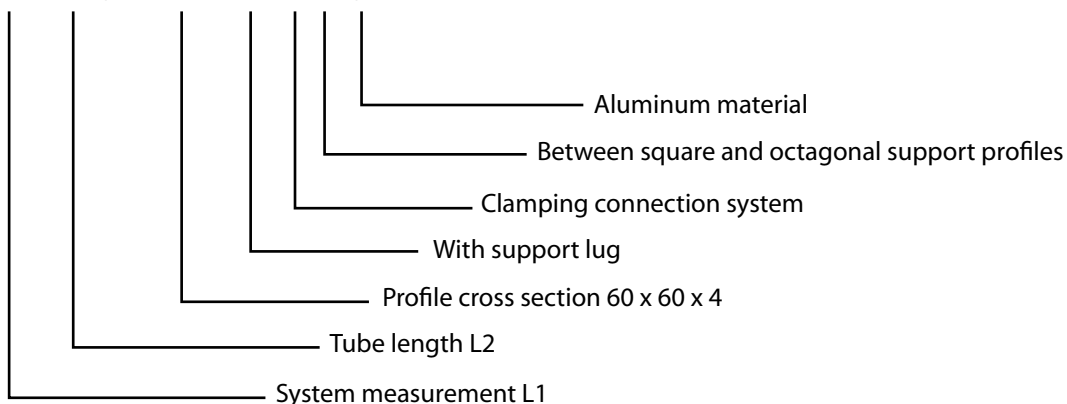

# System Technology, Vertical Dimensions

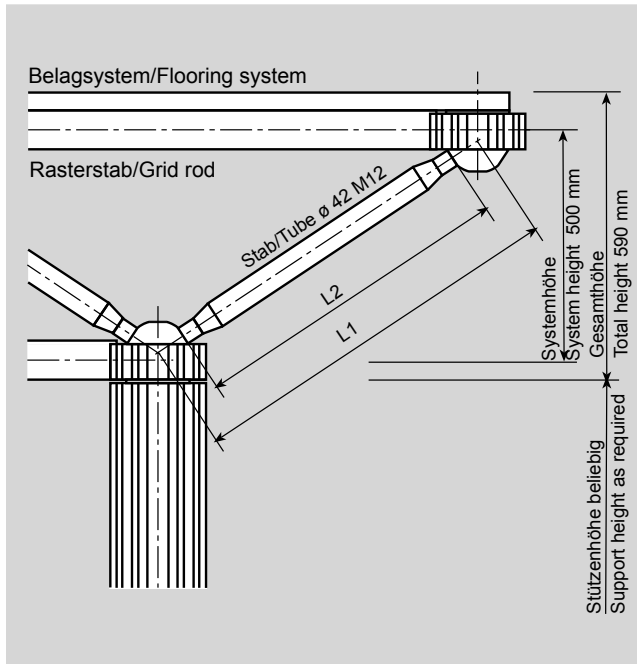

Vertical dimensions of space frame

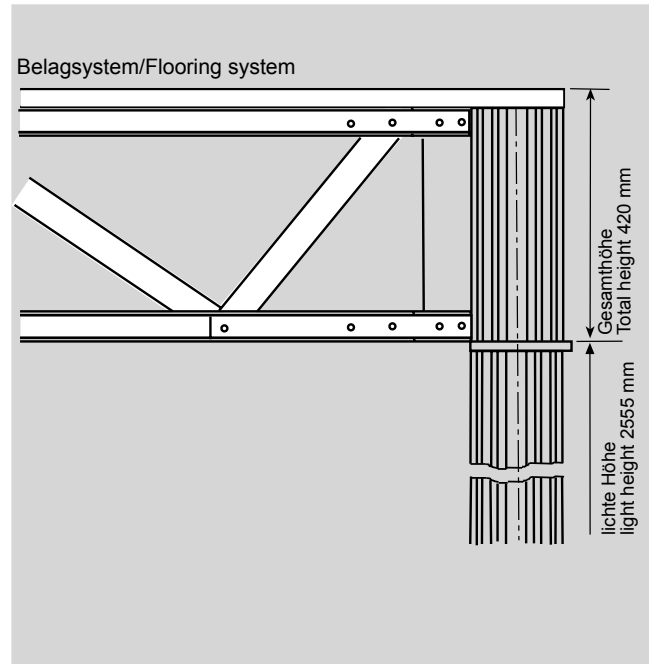

Vertical dimensions of load bearing girder

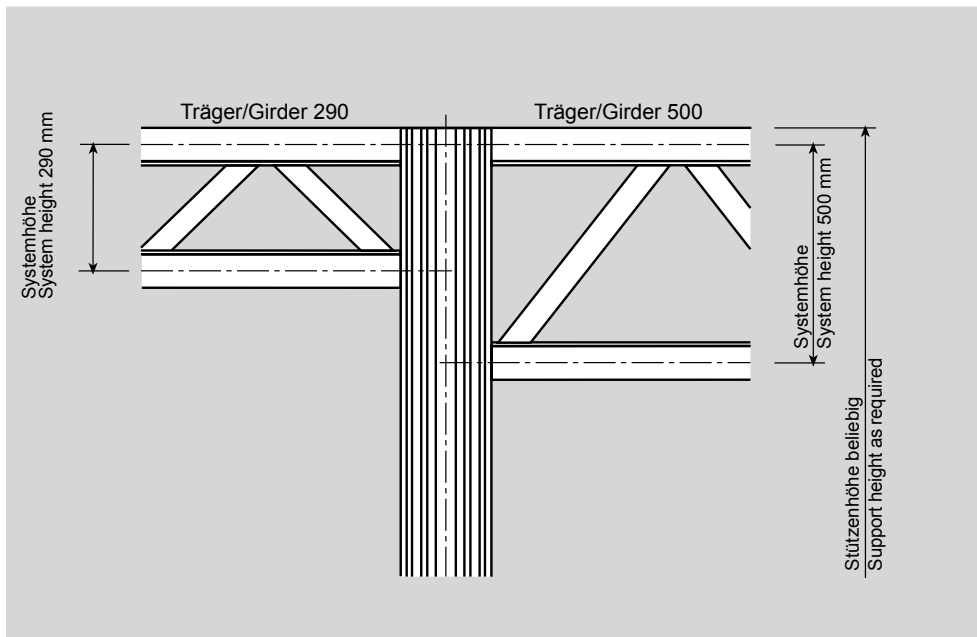

Vertical dimensions of frame girder

# Components

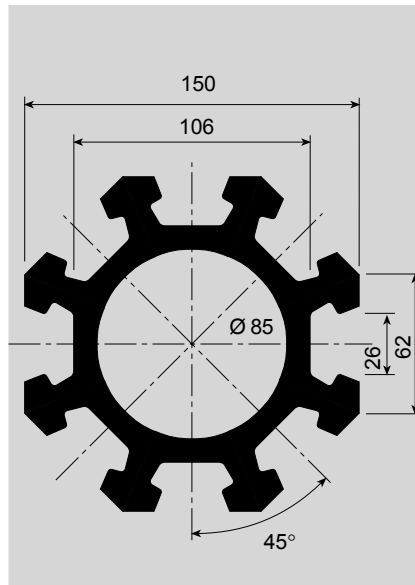
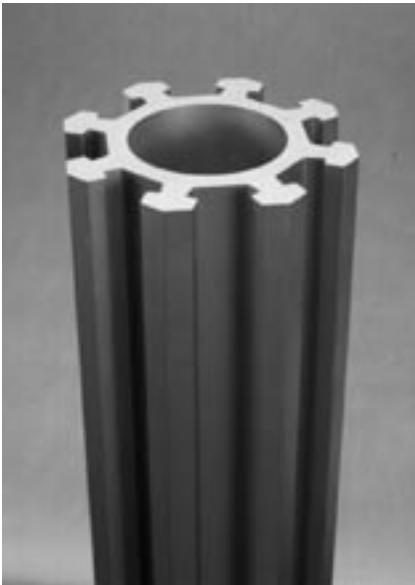

## Supporting Section Octagonal

SW 150 mm, aluminium.

For statically stressed columns i.e. in two-story stand constructions.

Bearing length 3700 mm

Weight: 20,100 kgs/mtr.

Part # 100124 raw  
100181 p.c.  
100242 E6EV1

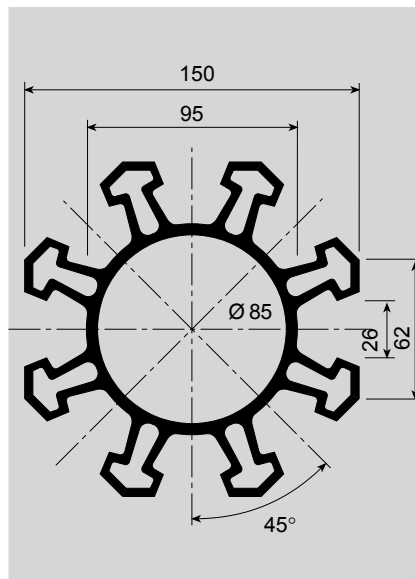
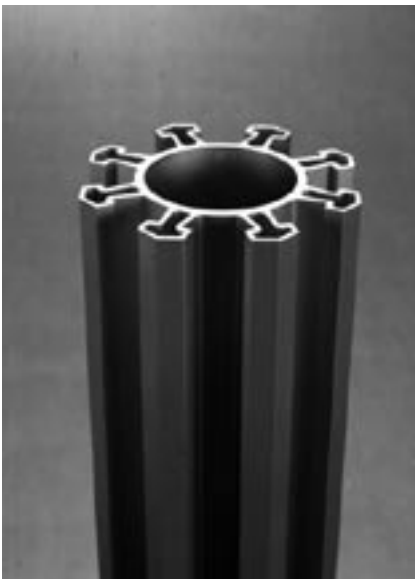

## Supporting Section HK Octagonal

SW 150 mm, aluminium.

For statically less stressed columns in predominantly decorative constructions and in wall constructions.

Bearing length 6000 mm

Weight: 9,500 kgs/mtr.

Part # 100222 raw  
100223 p.c.  
100243 E6EV1

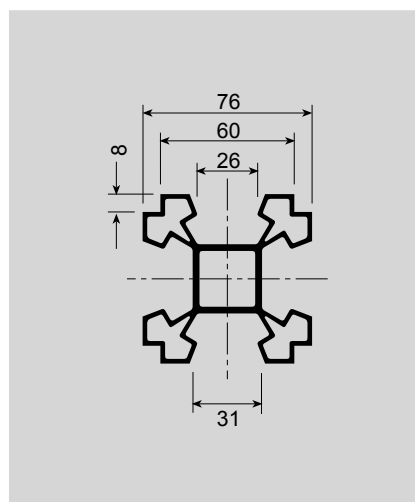

## Supporting Section Square

76 mm, aluminium.

For statically less stressed columns in predominantly decorative constructions and in wall constructions.

Bearing length 6000 mm

Weight: 2,900 kgs/mtr.

Part # 100125 raw  
100180 p.c.  
100241 E6EV1

**Please note:** The articles on this page are not included in our price list. Price on request (please indicate part # and requested length).

# Components

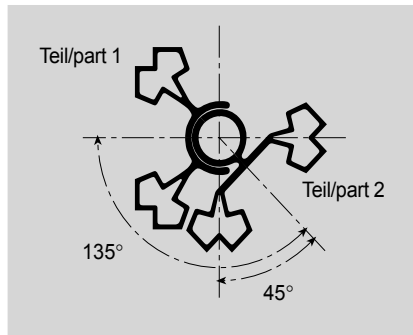
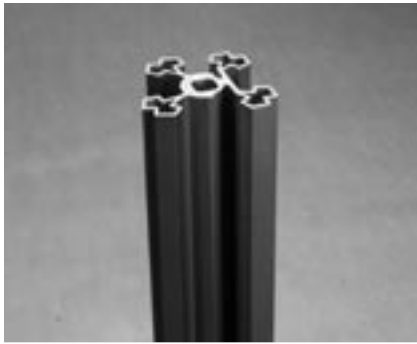

## Wall Support Profile Vario

aluminium, with variable angle adjustable up to 135°, consists of two parts.

Bearing length 6000 mm

Weight 3,490 kgs/mtr.

Part # 100235 raw  
100236 lp.c.  
100237 E6EV1

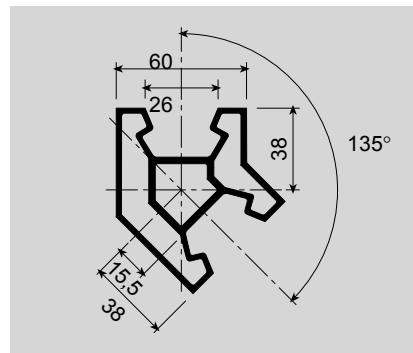

## Wall Supporting Section 135°

aluminium, 2 connection directions at an angle of 135°.

Bearing length 6000 mm

Weight: 2,550 kgs/mtr.

Part # 100196 raw  
100197 p.c.  
100230 E6EV1

**Please note:** The articles on this page are not included in our price list. Price on request (please indicate part # and requested length).

# Components

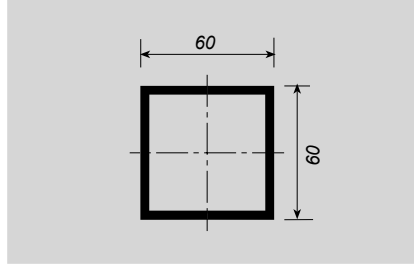

## Grid rod 60 x 4 LK

Aluminium. Used as a frame between the nodes SW 150, with D2 clamp joints at both ends (front side smooth). For walkable 4D space frames. Fitted with additional 1.5 mm thick rubber coating in the upper chord of the space frame, this is used to provide impact sound insulation from the upper-level flooring system.

		<b>4/4</b>	<b>4/8</b>	<b>8/8</b>
<b>500 mm</b>	Weight:	1,560 kgs.	1,470 kgs.	1,380 kgs.
	Part #:	21548 raw 21549 p.c. 504924 E6EV1	21556 raw 21557 p.c. 504920 E6EV1	21540 raw 21541 p.c. 504916 E6EV1
<b>707 mm</b>	Weight:	1,680 kgs.	2,060 kgs.	1,970 kgs.
	Part #:	21558 raw 21559 p.c. 504936 E6EV1	21550 raw 21551 p.c. 504932 E6EV1	21542 raw 21543 p.c. 504928 E6EV1
<b>1000 mm</b>	Weight:	2,760 kgs.	2,670 kgs.	2,580 kgs.
	Part #:	21552 raw 21553 p.c. 504948 E6EV1	21560 raw 21561 p.c. 504944 E6EV1	21544 raw 21545 p.c. 504940 E6EV1
<b>1414 mm</b>	Weight:	3,770 kgs.	3,670 kgs.	3,590 kgs.
	Part #:	21554 raw 21555 p.c. 504963 E6EV1	21562 raw 21563 p.c. 504959 E6EV1	21546 raw 21547 p.c. 504954 E6EV1
<b>2000 mm</b>	Weight:	5,400 kgs.	5,400 kgs.	5,400 kgs.
	Part #:	21656 raw 21655 p.c. 504975 E6EV1	21658 raw 21657 p.c. 504971 E6EV1	21660 raw 21659 p.c. 504967 E6EV1

# Components

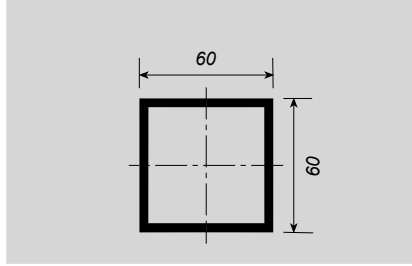

## Grid rod 60 x 4 K

Aluminium. Used as a frame between the support profiles, with D1 clamp joints at both ends (front side grooved). For walkable 4D spaceframes.

		4/4	4/8	8/8
<b>500 mm</b>	Weight:	1,560 kgs.	1,470 kgs.	1,380 kgs.
	Part #:	21476 raw 21477 p.c. 504923 E6EV1	21484 raw 21485 p.c. 504919 E6EV1	21468 raw 21469 p.c. 504915 E6EV1
<b>707 mm</b>	Weight:	2,060 kgs.	1,970 kgs.	1,680 kgs.
	Part #:	21478 raw 21479 p.c. 504935 E6EV1	21486 raw 21487 p.c. 504931 E6EV1	21470 raw 21471 p.c. 504927 E6EV1
<b>1000 mm</b>	Weight:	2,760 kgs.	2,670 kgs.	2,580 kgs.
	Part #:	21480 raw 21481 p.c. 504947 E6EV1	21488 raw 21489 p.c. 504943 E6EV1	21472 raw 21473 p.c. 504939 E6EV1
<b>1414 mm</b>	Weight:	3,770 kgs.	3,670 kgs.	3,590 kgs.
	Part #:	21482 raw 21483 p.c. 504962 E6EV1	21490 raw 21491 p.c. 504958 E6EV1	21474 raw 21475 p.c. 504953 E6EV1
<b>2000 mm</b>	Weight:	5,100 kgs.	5,100 kgs.	5,100 kgs.
	Part #:	21650 raw 21649 p.c. 504974 E6EV1	21652 raw 21651 p.c. 504970 E6EV1	21654 raw 21653 p.c. 504966 E6EV1

# Components

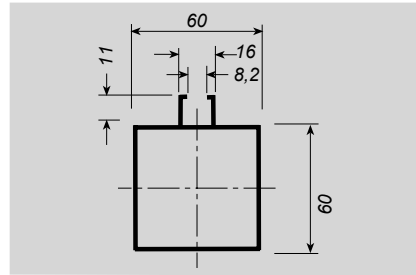

## Grid rod 60 x 2 NK

Aluminium. With fastening grooves, for example for frame girder diagonals, with D1 clamp joints at both ends (front side grooved). For non-walkable supporting structures consisting of frame girders and wall constructions.

		<b>4/4</b>	<b>4/8</b>	<b>8/8</b>
<b>500 mm</b>	Weight:	1,610 kgs.	1,520 kgs.	1,430 kgs.
	Part #:	21524 raw 21525 p.c. 504925 E6EV1	21532 raw 21533 p.c. 504921 E6EV1	21516 raw 21517 p.c. 504917 E6EV1
<b>707 mm</b>	Weight:	2,140 kgs.	2,050 kgs.	1,960 kgs.
	Part #:	21526 raw 21527 p.c. 504937 E6EV1	21534 raw 21535 p.c. 504933 E6EV1	21518 raw 21519 p.c. 504929 E6EV1
<b>1000 mm</b>	Weight:	2,890 kgs.	2,800 kgs.	2,700 kgs.
	Part #:	21528 raw 21529 p.c. 504949 E6EV1	21536 raw 21537 p.c. 504945 E6EV1	21520 raw 21521 p.c. 504941 E6EV1
<b>1414 mm</b>	Weight:	3,960 kgs.	3,860 kgs.	3,870 kgs.
	Part #:	21530 raw 21531 p.c. 504964 E6EV1	21538 raw 21539 p.c. 504960 E6EV1	21522 raw 21523 p.c. 504955 E6EV1
<b>2000 mm</b>	Weight:	5,500 kgs.	5,500 kgs.	5,500 kgs.
	Part #:	21662 raw 21661 p.c. 504976 E6EV1	21664 raw 21663 p.c. 504972 E6EV1	21666 raw 21665 p.c. 504968 E6EV1

# Components

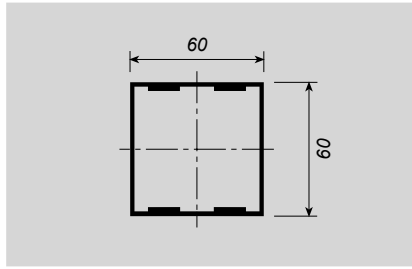

## Grid rod 60 x 2 K

Aluminium. Used as a frame between the support profiles, with D1 clamp joints at both ends (front side grooved). For non-walkable supporting structures consisting of frame girders and wall constructions.

		<b>4/4</b>	<b>4/8</b>	<b>8/8</b>
<b>500 mm</b>	Weight:	1,190 kgs.	1,130 kgs.	1,080 kgs.
	Part #:	21500 raw 21501 p.c. 504922 E6EV1	21508 raw 21509 p.c. 504918 E6EV1	21492 raw 21493 p.c. 504914 E6EV1
<b>707 mm</b>	Weight:	1,151 kgs.	1,420 kgs.	1,040 kgs.
	Part #:	21502 raw 21503 p.c. 504934 E6EV1	21510 raw 21511 p.c. 504930 E6EV1	21494 raw 21495 p.c. 504926 E6EV1
<b>1000 mm</b>	Weight:	1,970 kgs.	1,910 kgs.	1,850 kgs.
	Part #:	21504 raw 21505 p.c. 504946 E6EV1	21512 raw 21513 p.c. 504942 E6EV1	21496 raw 21497 p.c. 504938 E6EV1
<b>1414 mm</b>	Weight:	2,610 kgs.	2,550 kgs.	2,490 kgs.
	Part #:	21506 raw 21507 p.c. 504961 E6EV1	21514 raw 21515 p.c. 504956 E6EV1	21498 raw 21499 p.c. 504951 E6EV1
<b>2000 mm</b>	Weight:	3,800 kgs.	3,800 kgs.	3,800 kgs.
	Part #:	21644 raw 21643 p.c. 504973 E6EV1	21646 raw 21645 p.c. 504969 E6EV1	21648 raw 21647 p.c. 504965 E6EV1

# Components

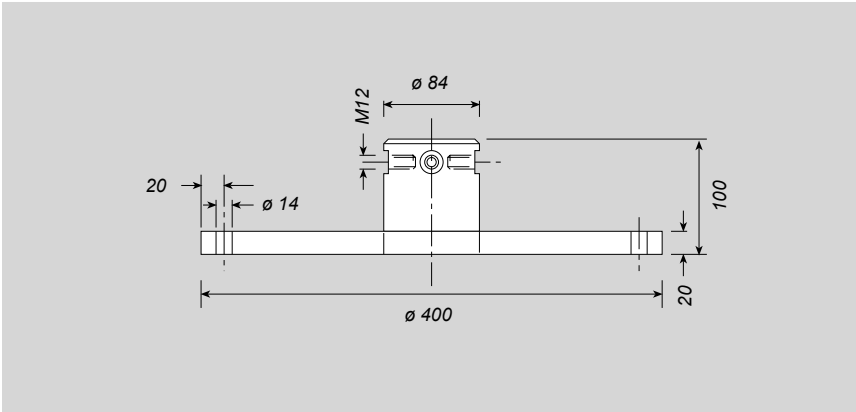

## Foot Plate Ø 400 mm

Steel, with steel cylinder welded in position, for SW 150 octagonal column profile.

Weight: 23,200 kgs.

Part # 21582 galv.  
21583 p.c.

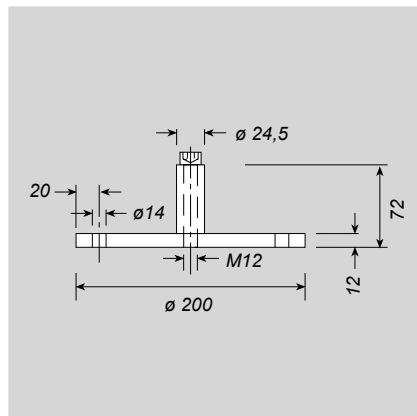

## Foot Plate Ø 200 mm

Steel, with screwed-on sleeve, for SW 76 square column profile.

Weight: 3,810 kgs.

Part # 21584 galv.  
21585 p.c.

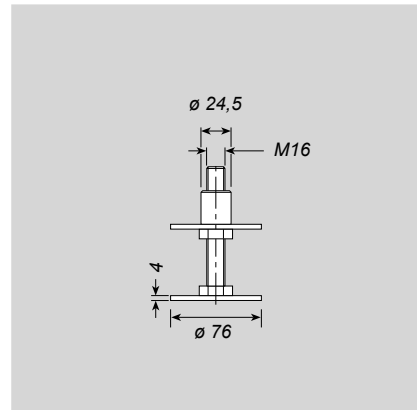

## Adjustable foot Ø 76 mm M16

With bearer sleeve, steel as base or top plate, adjustable in height from 26,5 - 102 mm (fitted using wrench SW 24).

Weight: 0,680 kgs.

Part # 21586 galv.  
21587 p.c.

# Wall System

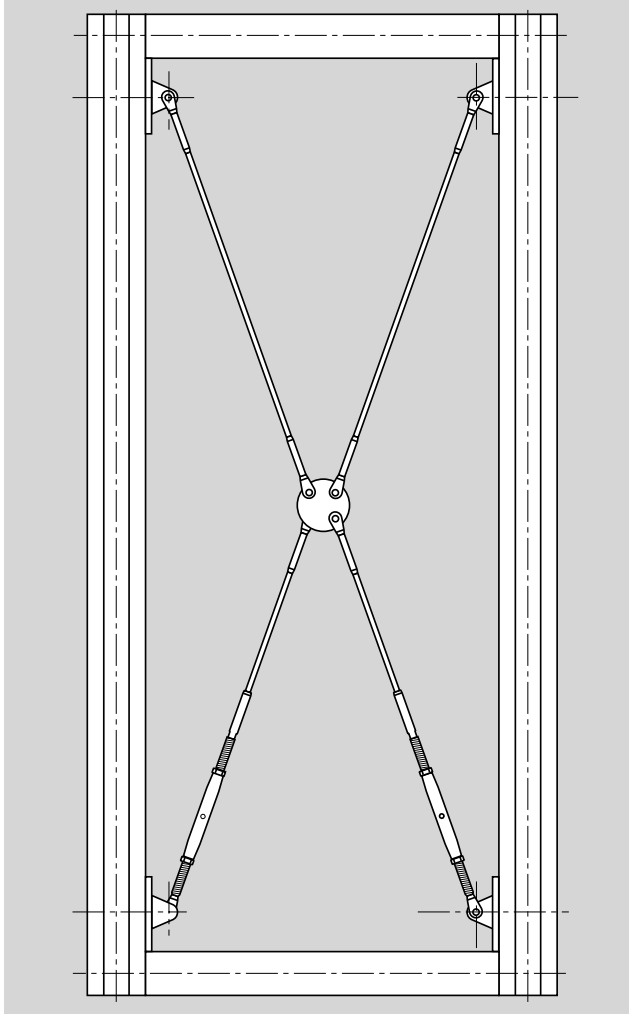

## Crossed steel cables

decorative, for grid fields without wall panels.

Consists of:

- four fixing devices for cable bracing
- two steel cables Ø 5 mm with jaws
- two steel cables Ø 5 mm with jaws/ tensioning unit
- one disk D70 for crossed cables

## Cable 5 mm, tensioning unit

Weight: 0,140 kgs.

Part # 501869

## Cable 5 mm, 2x Jaws

Weight: 0,140 kgs.

Part # 501868

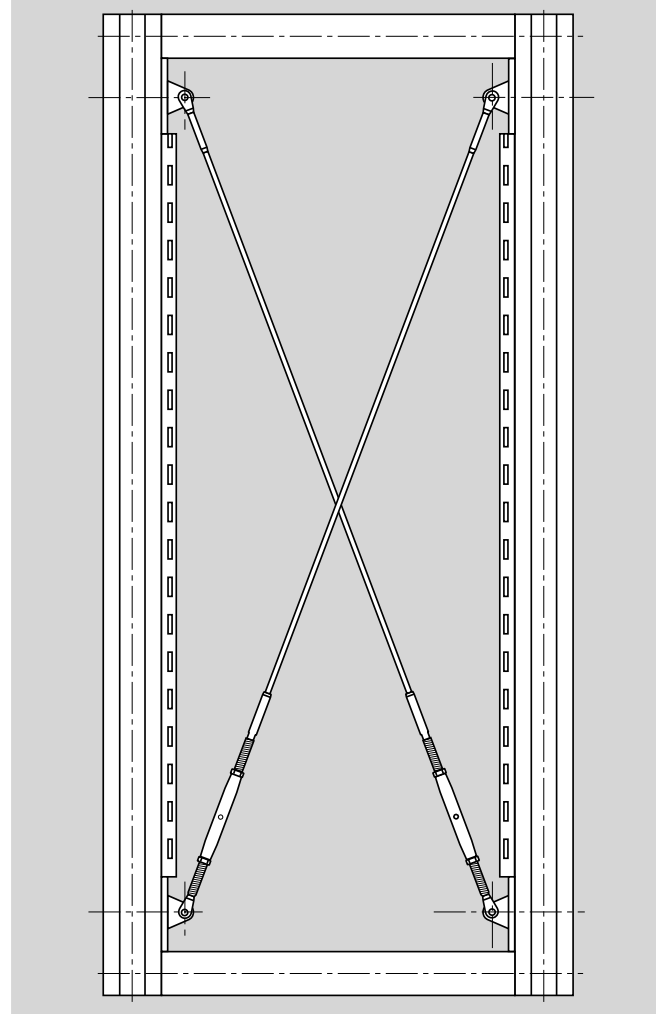

## Crossed steel cables, for grid fields with wall panel cladding.

Consists of:

- four fixing devices for cable bracing
- two cables Ø 5 mm

## Fixing Device for Cable Bracing

Weight: 0,300 kgs.

Part # 10708 raw  
21679 p.c.

## Disk D70 for Crossed Cables

Weight: 0,140 kgs.

Part # 501866 galv.  
501867 p.c.

# Wall System

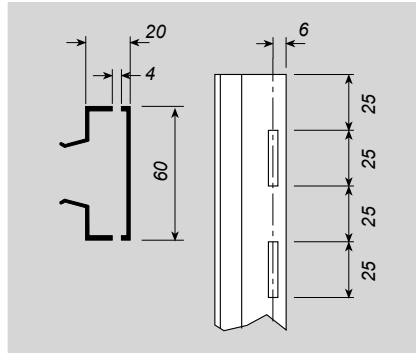
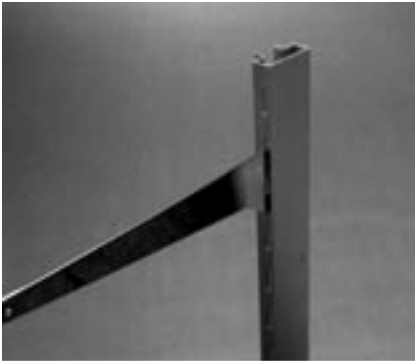

**Clamp profile 60 x 20, Slotted**  
Aluminium, is clamped onto the supporting section. To accept different cladding materials. Max. length 5500mm.

Weight: 0,600 kgs

Part # 100126 p.c.  
505527 E6EV1

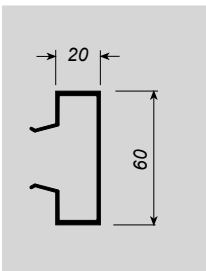

**Clamp Profile 60 x 20**  
Aluminium, max. length 5500 mm.

Weight: 0,630 kgs/mtr.

Part # 100127 p.c.  
505525 E6EV1

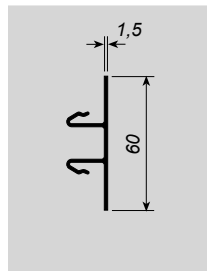

**Clamp Profile 60 x 1.5**  
Aluminium, max. length 5500mm.

Weight: 0,320 kgs/mtr.

Part # 100164 p.c.  
505341 E6EV1

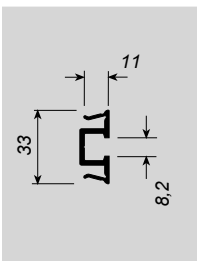

**Clamp Profile with Groove 8.2 mm**  
Aluminium, max. length 5500mm.

Weight: 0,380 kgs./mtr.

Part # 100218 p.c.  
505529 E6EV1

**Clamp Profile 60x1,5**  
Aluminium, profile section 40mm.

PU: 50 pcs.

Weight: 0,014 kgs.

Part # 502705 p.c. 9006

**Please note:** The clamp profiles with max. length are not included in our price list. Price on request (please indicate part # and requested length).

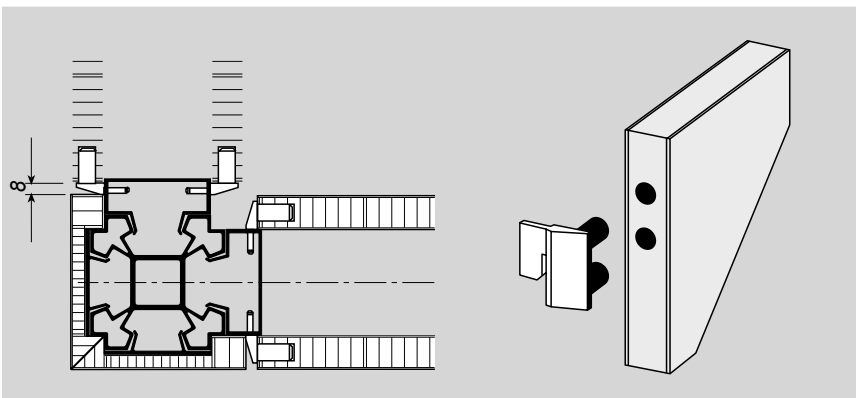

**Panel Attachment**  
Plastic, left/right. For the cladding of the 4D construction by using clamp profiles 60x20.

Weight: 0,010 kgs.

PU: 50 pairs.

Part # 20697 white

# Wall System

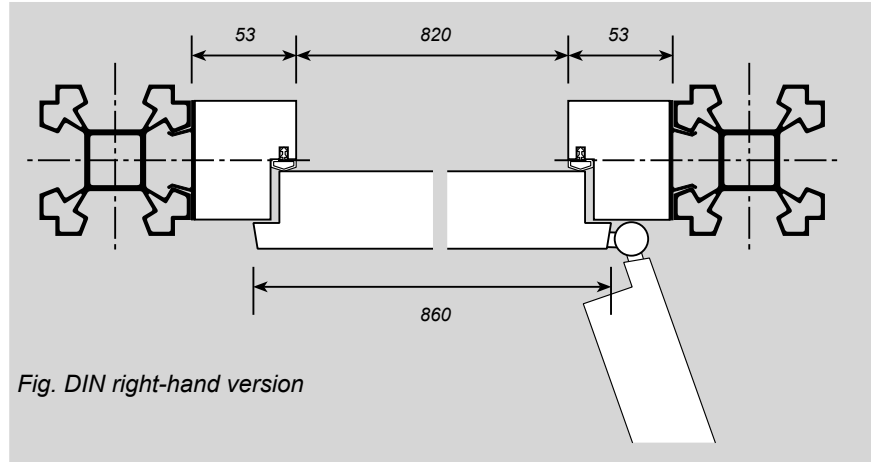
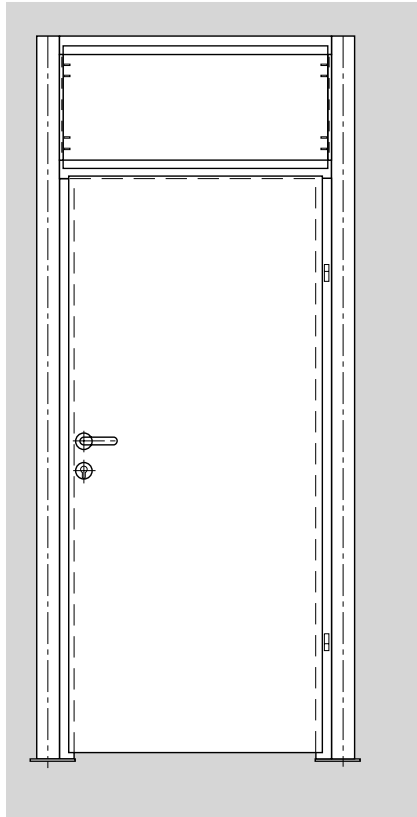

Fig. DIN right-hand version

## DIN L 2000x1000mm 4/4

### Door Element 4D

Wood, between two support profiles, 76 mm square, complete, scope of delivery: door leaf 40 mm, door handle fittings with profile cylinder with 3 keys, locking differently, wooden door frame, with 60 x 1.5 clamp profile.

Weight: 40,000 kgs.

Part # 21877 p.c.  
21876 p.c. 9016

## DIN R 2000x1000mm 4/4

Weight: 40,000 kgs.

Part # 21875 p.c.  
21874 p.c. 9016

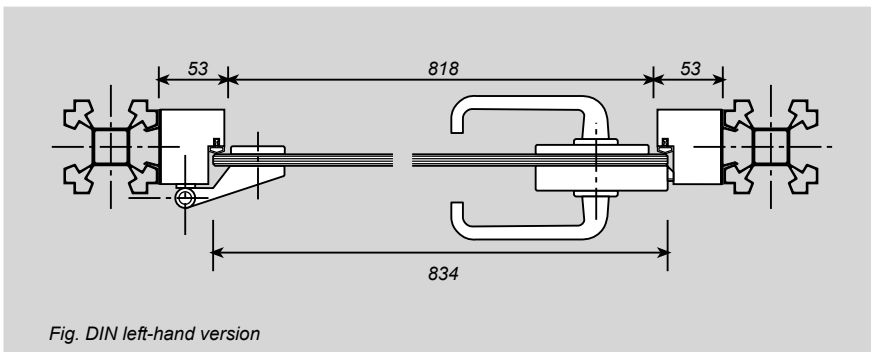
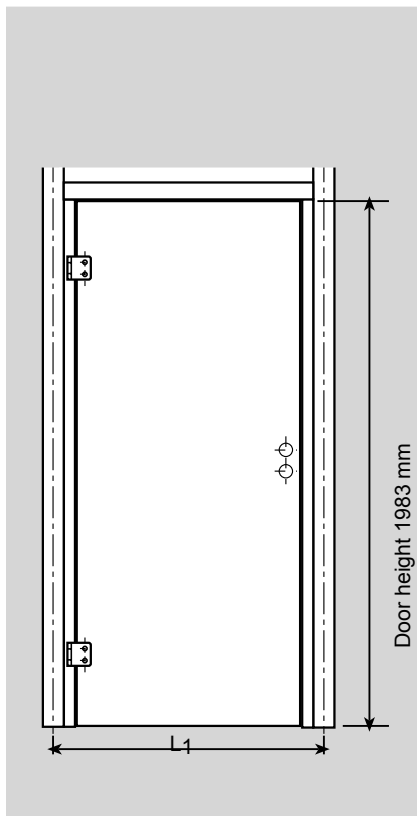

Fig. DIN left-hand version

### 4D Glass Door Element

between two support profiles, 76 mm square, complete, scope of delivery: door leaf Float ESG 8 mm, hinge plates white, door handle fittings, white, with profile cylinder with 3 keys, locking differently, wooden door frame, p.c. white, with 60 x 1.5 clamp profile.

Price on request!

Technical sheets available on request!

# Wall System

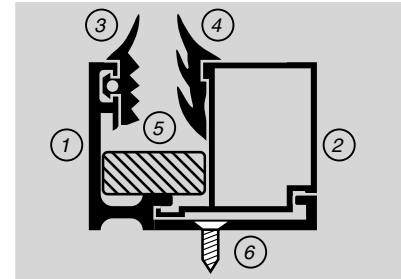
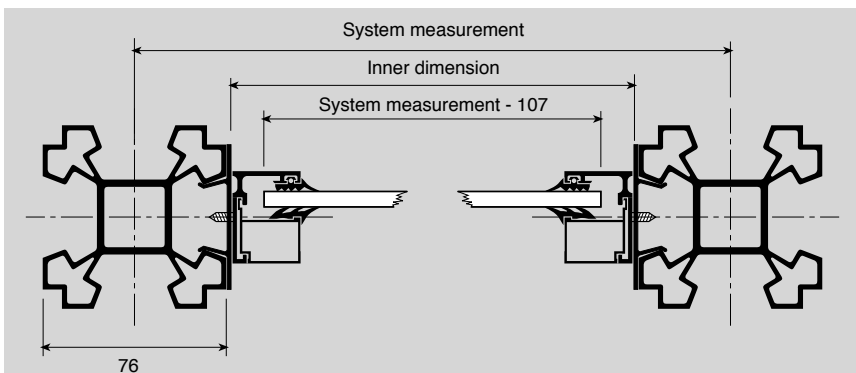
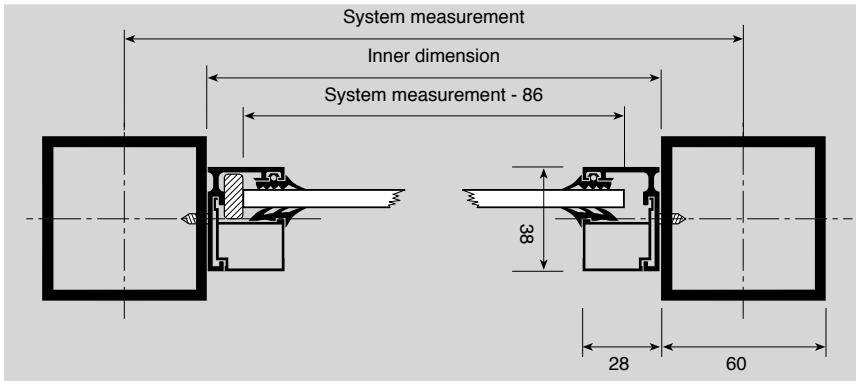

## Glazing Profile

Delivery scope:

1. Bolt-on profile, aluminium  
Cut ..., max. length 6500 mm
2. Glass fitting strip (19 mm) for 6 mm glass, Cut ..., max. length 6500 mm
3. External glazing sealing, black  
Cut ..., max. length 200 m
4. Inner glazing sealing, black  
Cut ..., max. length 200 m
5. Plywood support, 16 x 7 mm ... 100
6. Countersunk screw B, 3.9 x 13, galvanized DIN 7982, pck. 20 pcs.

Weight: 0,820 kgs.

Part # 100240 E6EV1  
100239 p.c.

**Please note:** The articles on this page are not included in our price list. Price on request (please indicate part # and requested length).

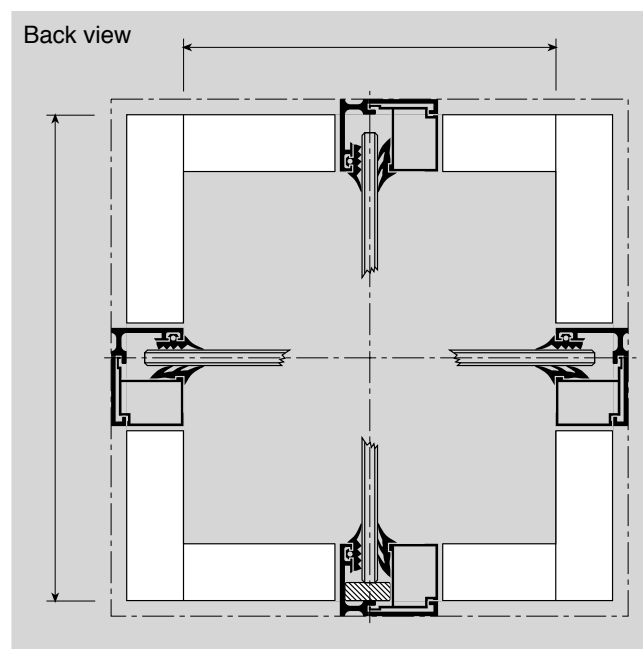
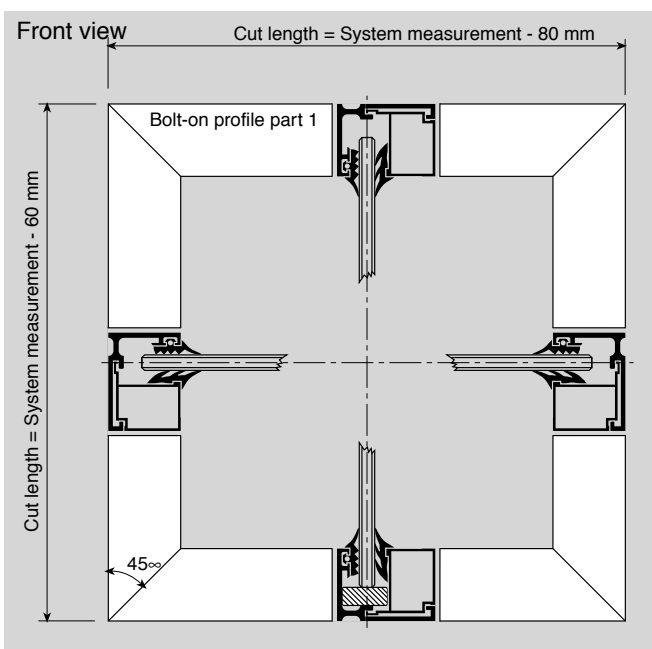

Profile for single glazing, cut measurements

# Spider Fixing Technique

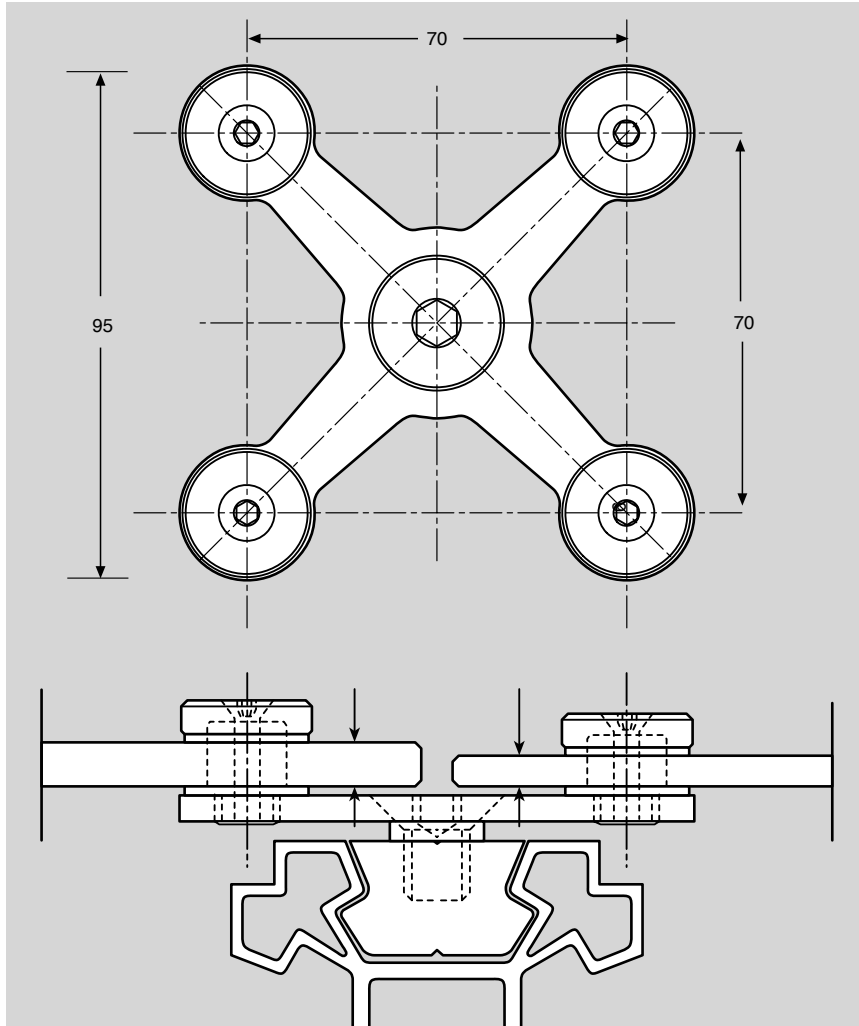

## Spider Fixing S

For bolted attachment, stainless steel, without central fixture. For descriptions and part numbers please see Component Catalogue M12 System. To connect with the 4D System you need the Central Fixture 21x56mm Spider S (description see page 33).

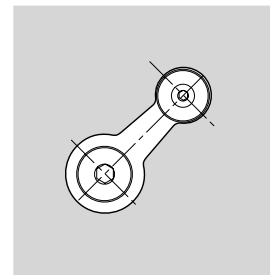
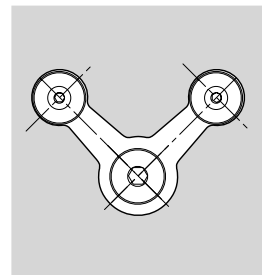
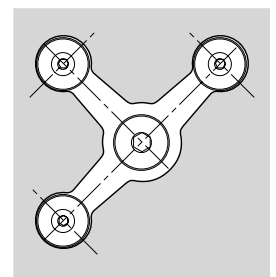
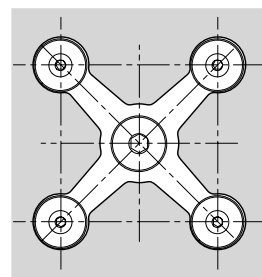
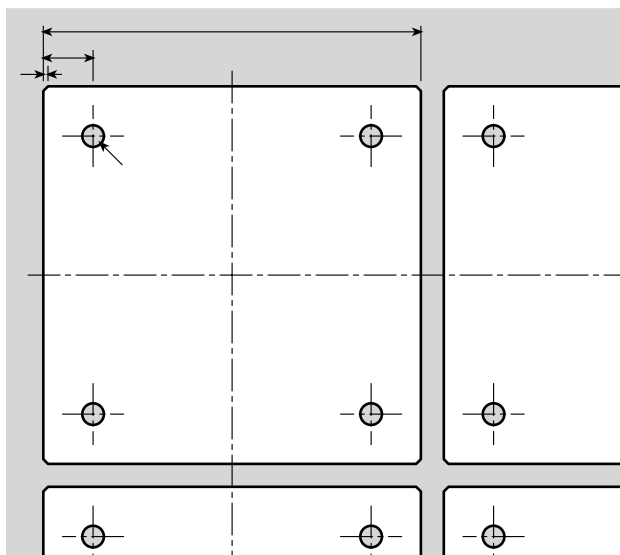

Panel sizes, technical sheets available on request!

# Spider Fixing Technique

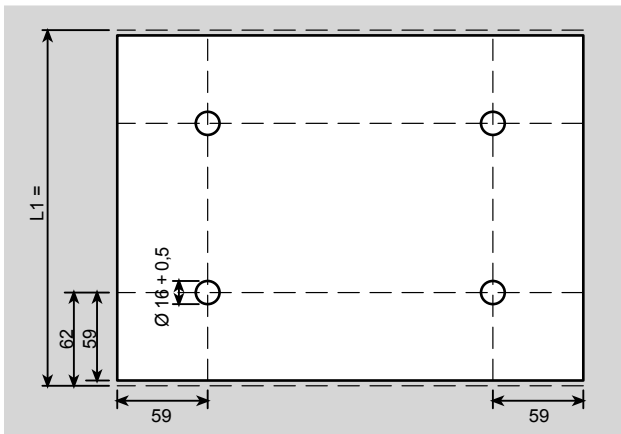
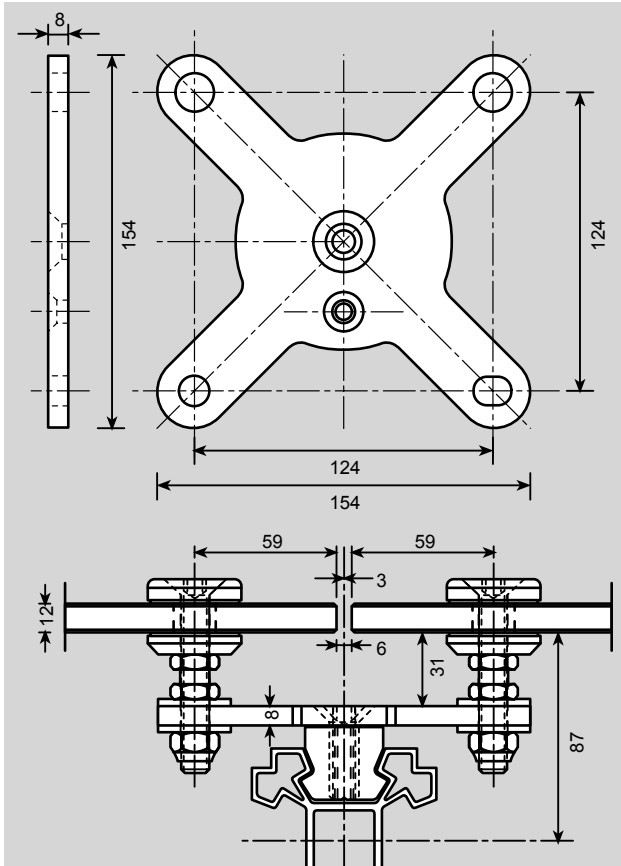

Panel sizes, technical sheets available on request!

## Set for Fixing for Spider Type L

Weight: 0,220 kgs.

Part # 504320

## Spider Fixture L

For bolted attachment, stainless steel, complete with Central Fixture (see page 34) to fix onto support profiles SW 76 and SW 150. To attach heavy and thick glass panels. For 12 mm glass (max. 1x2,5 m).

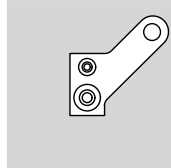

### Spider Fixture L Type I l.o.

Weight 0,757 kg

Part # 504275

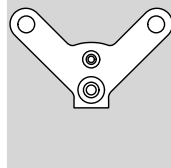

### Spider Fixture L Type II m.o.

Weight 1,117 kg

Part # 504279

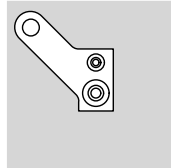

### Spider Fixture L Type I r.o.

Weight 1,757 kg

Part # 504276

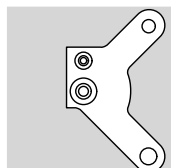

### Spider Fixture L Type II l.m.

Weight 1,117 kg

Part # 504280

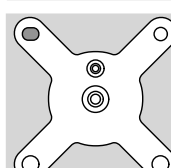

### Spider Fixture L Type IV m.

Weight 2,007 kg

Part # 504283

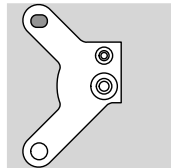

### Spider Fixture L Type II r.m.

Weight 1,117 kg

Part # 504281

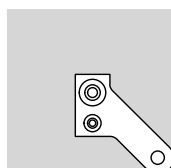

### Spider Fixture L Type I l.u.

Weight 0,757 kg

Part # 504277

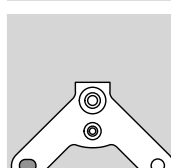

### Spider Fixture L Type II m.u.

Weight 1,117 kg

Part # 504282

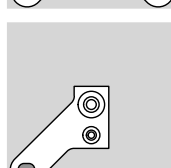

### Spider Fixture L Type I r.u.

Weight 0,757 kg

Part # 504278

# Double Deck: Space Frame

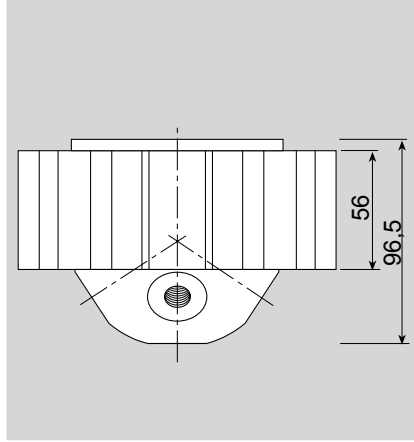

**Node SW150 Octagonal AL**  
Aluminium, coupling element to the grid tubes for the construction of walkable space frames.

Weight: 2,150 kgs.

Part # 21588 raw  
21589 p.c.

**Node SW150 Octagonal ST**  
Steel, coupling element to the grid tubes for the construction of walkable space frames. Especially used for supports.

Weight: 2,150 kgs.

Part # 21590 p.c.

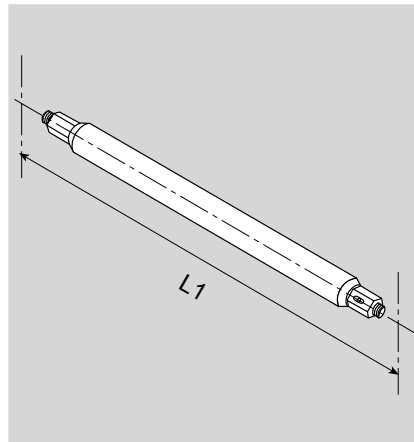

**Diagonal Tubes 42 M12 SW28 ST**

**Length 500mm**

Weight: 1,100 kgs.

Part # 21591 h.d.g.  
21592 p.c.

**Length 686mm**

Weight: 1,600 kgs.

Part # 21593 h.d.g.  
21594 p.c.

**Length 849mm**

Weight: 2,070 kgs.

Part # 21595 h.d.g.  
21596 p.c.

# Double Deck: Space Frame

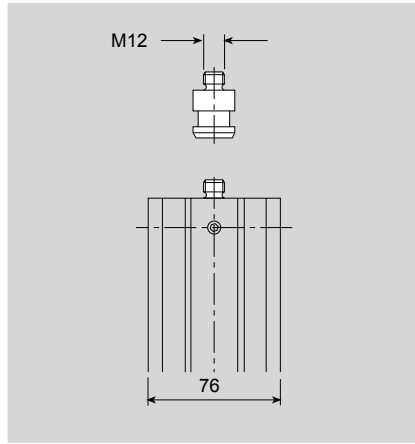
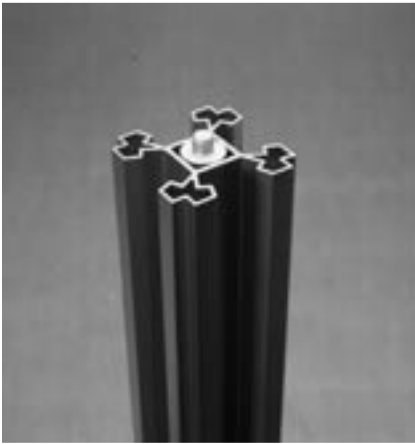

**Connecting Piece Square Profile**  
SW 76, steel, with 2 M8 x 8 DIN 913  
A2 setscrews.

Weight: 0,100 kgs.

Part # 21403 dac.  
505086 galv.

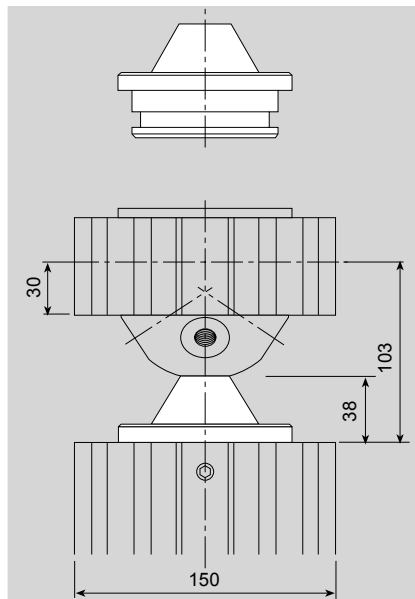

**Support Square Profile SW 76**  
Steel, fully Dacromet coated,  
with M12 x 80 cheese head bolt  
and 2 M8 x 8 DIN 913 A2 setscrews.

Weight: 0,750 kgs.

Part # 21404 galv.  
503598 p.c.

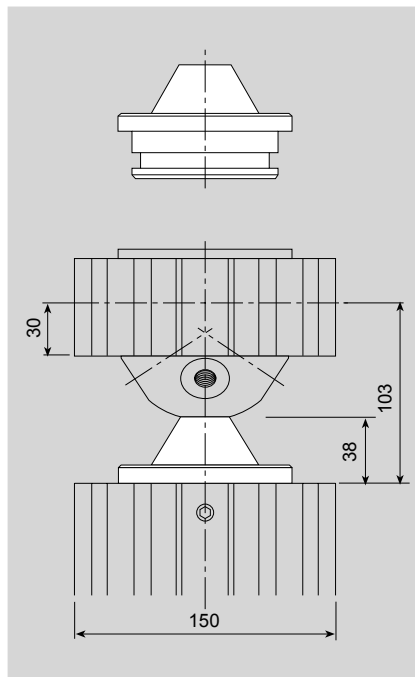

**Support Octagonal Profile SW 150**  
Steel, fully Dacromet coated,  
with M12 x 50 cheese head bolt  
and 2 M12 x 12 DIN 914 A2 setscrews.

Weight: 1,980 kgs.

Part # 21406 galv.  
503597 p.c.

# Double Deck: Space Frame

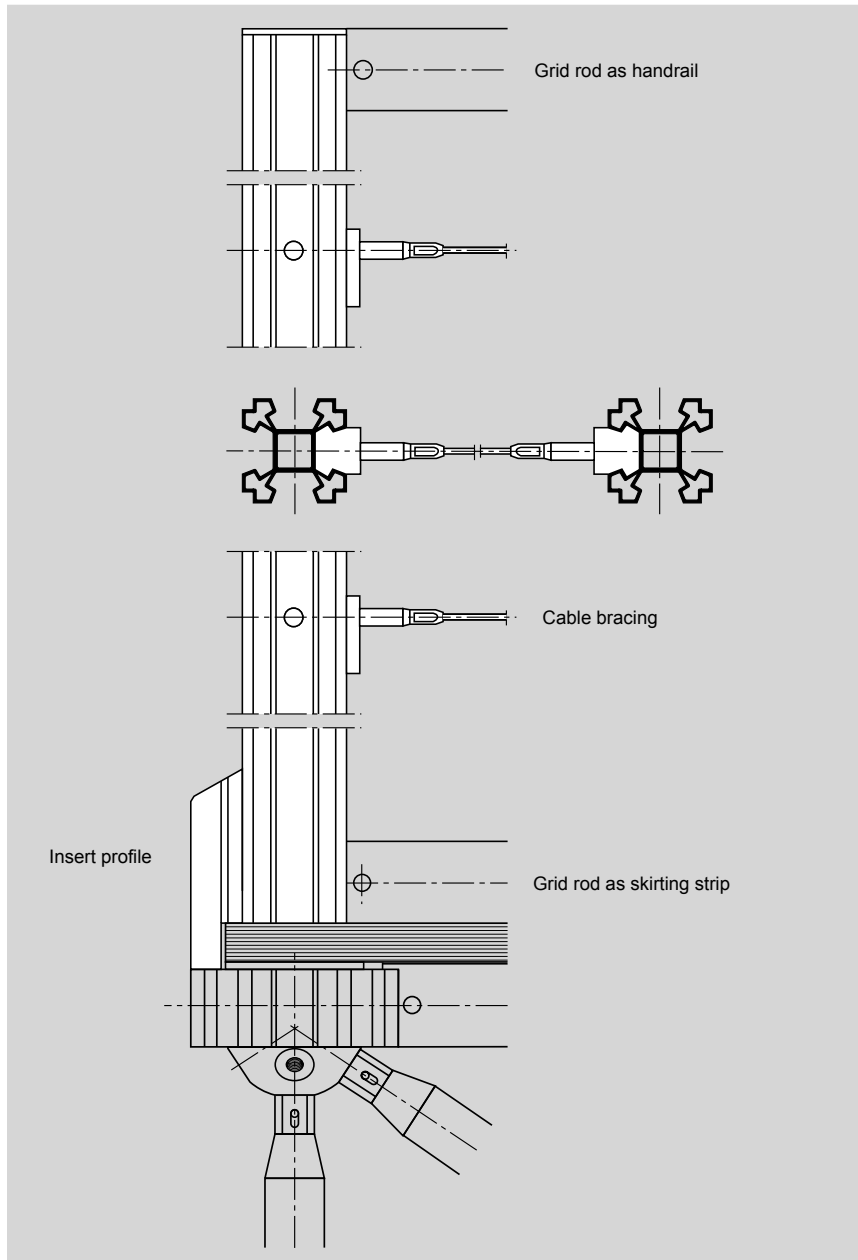

## Railing Post 100 mm, 76 x 76

Aluminium. Scope of delivery:

- 1 pc. SW 76 support profile
- 1 pc. fixing device, Type I and Type II
- 2 pcs. M12x60 cylindrical bolt
- 1 pc. spacer
- 2 pcs. M12x20 setscrew
- 1 pc. M12x100 8.8 cylindrical bolt
- 1 pc. 24.5x60 steel sleeve
- 1 pc. M8 stop bush
- 1 pc. cap, aluminium
- 1 pc. M8x10 countersunk bolt

Weight: 4,000 kgs.

Part # 21597 raw

Part # 21598 p.c.

## Cable Bracing

Steel, complete with 2 central fixtures for railing cable M12

### 1000 mm

Weight: 0,282 kgs.

Part # 10696 galv.

### 2000 mm

Weight: 0,322 kgs.

Part # 10697 galv.

### 3000 mm

Weight: 0,362 kgs.

Part # 10698 galv.

### 4000 mm

Weight: 0,402 kgs.

Part # 10699 galv.

# Double Deck: Load Bearing Girder

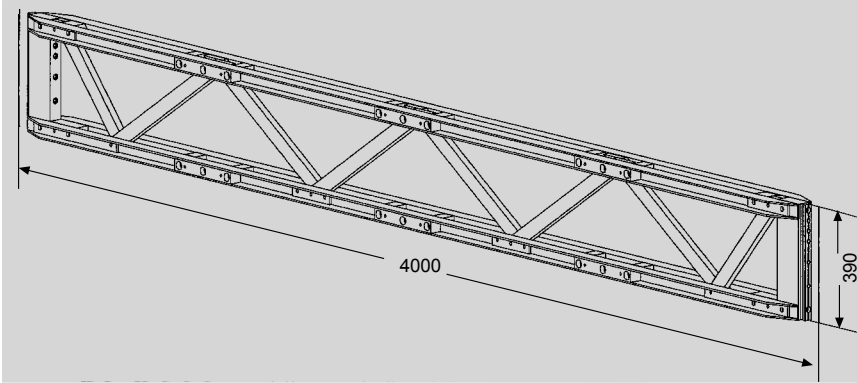

## TR Main Girder

Aluminium. The Main Girders form the frame for the load bearing girder grid are connected to the Support Profile by means of the Octagonal Support.

### Length 1000 mm

Weight: 30,000 kgs.

Part # 504451 E6EV1

### Length 2000 mm

Weight: 49,000 kgs.

Part # 504450 E6EV1

### Length 3000 mm

Weight: 70,000 kgs.

Part # 504449 E6EV1

### Length 4000 mm

Weight: 90,000 kgs.

Part # 504448 E6EV1

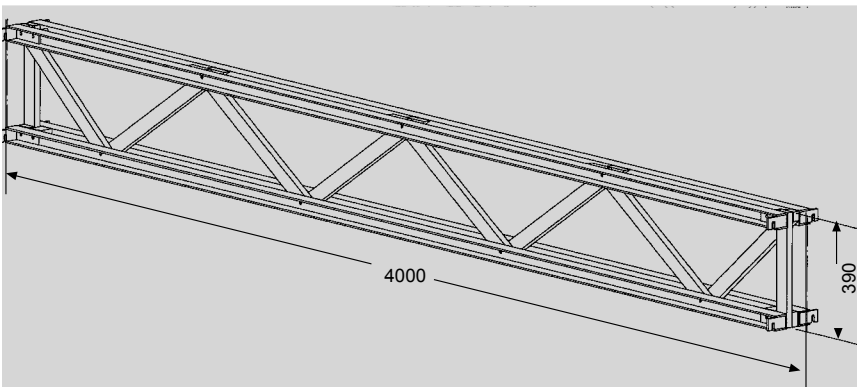

## TR Connecting Girder

Aluminium. Is connected to the main girder. The connecting girders form the filling of the load bearing girder grid.

### Length 2000mm

Weight: 27,000 kgs.

Part # 504565 E6EV1

### Length 3000mm

Weight: 39,000 kgs.

Part # 504537 E6EV1

### Length 4000mm

Weight: 58,000 kgs.

Part # 504452 E6EV1

# Double Deck: Load Bearing Girder

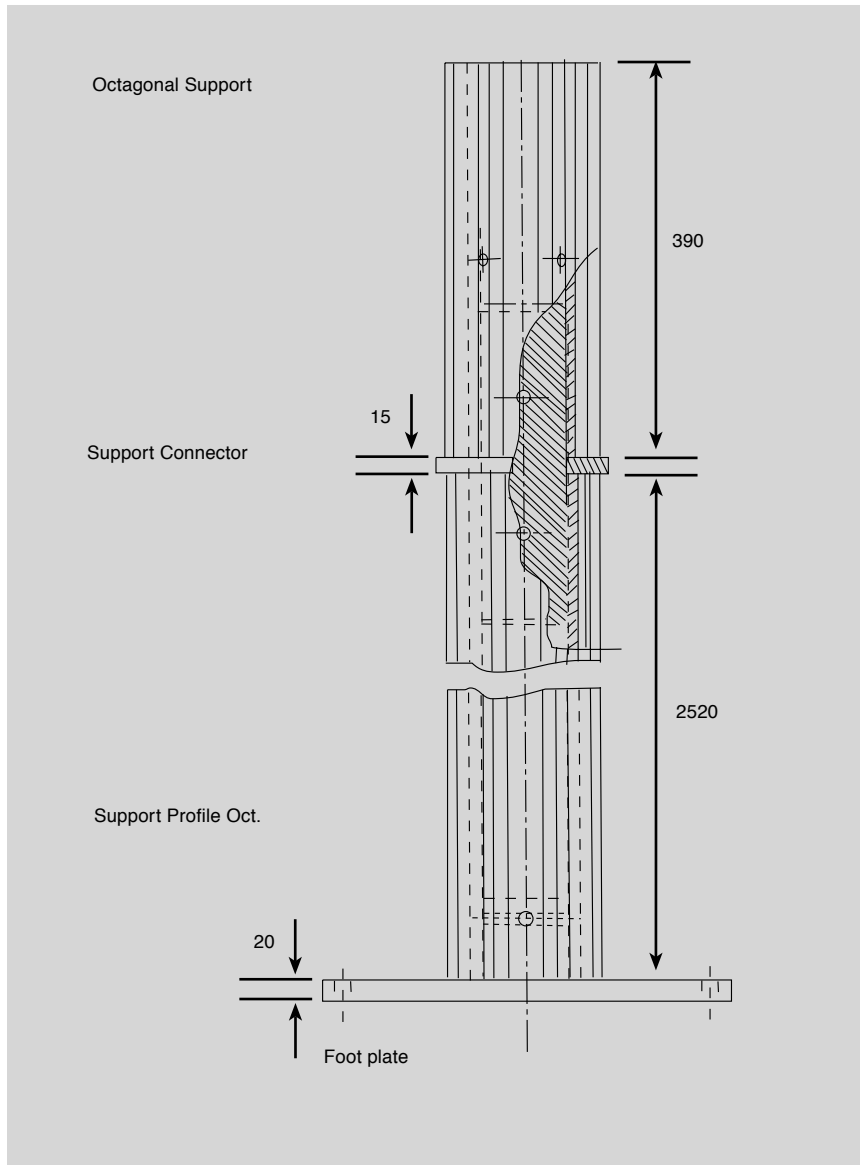

## TR Octagonal Support

Aluminium, 390mm. Connection between main girders.

Weight: 7,900 kgs.

Part # 504569 E6EV1

## TR Support Profile Octagonal

Aluminium, 2520mm. Support SW 150mm fitted for Load Bearing Girder.

Weight: 59,200 kgs.

Part # 504568 E6EV1

## TR Support Connector

Steel with 15 mm coil. Serves as connection between the Support Profile Octagonal and the Octagonal Support.

Weight: 12,100 kgs.

Part # 504797 galv.

**Foot Plate (see page 12)**

# Double Deck: Load Bearing Girder

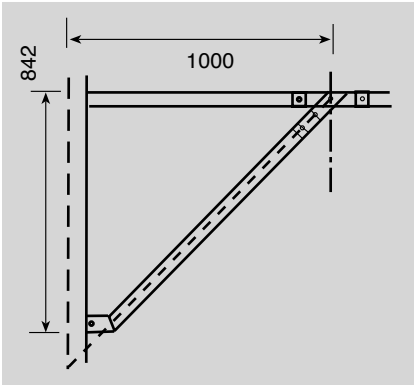

## TR Diagonal Brace Stiffener

Aluminium. To reduce vibrations on the load bearing girder construction.

Weight: 4,000 kgs

Part # 504630 raw  
504770 E6EV1

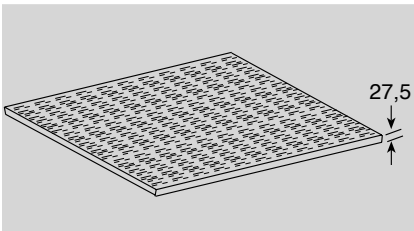

## TR Panels

multiply glued plywood panel

## TR Standard Panel 999x999

Weight: 19,000 kgs

Part # 504729

## TR Perimeter Panel 999x1074

Weight: 20,000 kgs

Part # 504730

## TR Corner Panel 1074x1074

Weight: 21,000 kgs

Part # 504731

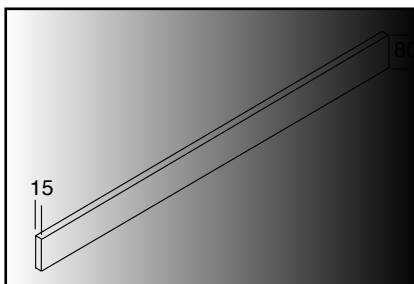

## TR Fascia

max. length 4 m. Strip of wood, rolling protection for open railing design (i.e. when cables as filling are used).

Part # 504737

## TR Lamello

PU: 50 pcs.

Weight: 0,100 kgs

Part # 504736

**Please note:** This article is not included in our price list. Price on request (please indicate part # and requested length).

# Double Deck: Load Bearing Girder

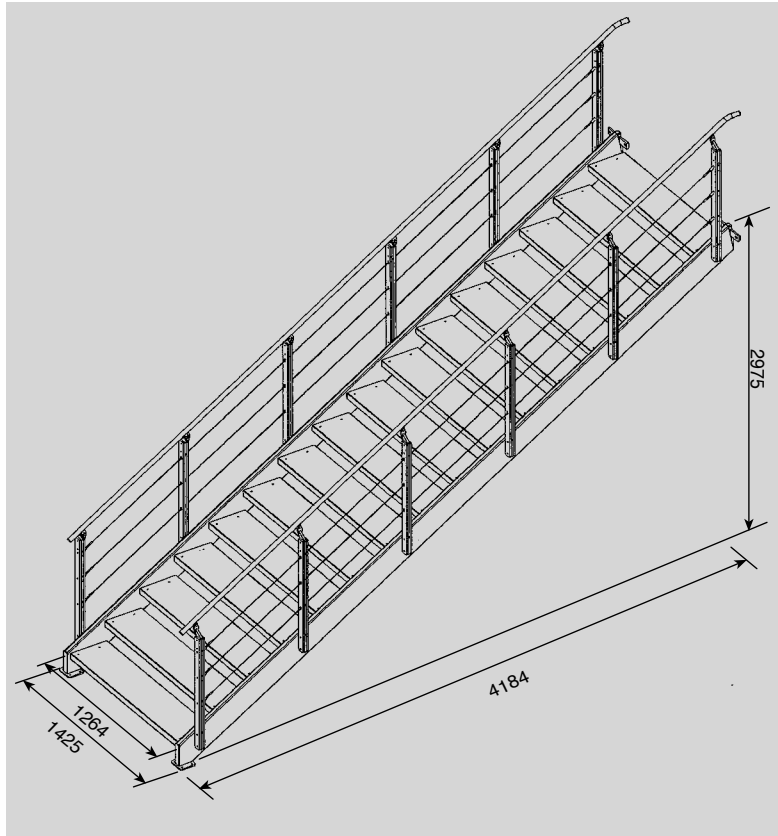

## TR Single Tracked Stair

Railing of aluminium, handrail and cables of stainless steel. Steps of 50 mm Multiplex beech, breadth 126 cm. Length of banquette 26 cm. Incl. railing of aluminium, handrails smoothed stainless steel tube  $\varnothing = 42$  mm, cladding stainless steel bracing.

Part # 504733

## TR Platform Stair

Railing of aluminium, handrail and cables of stainless steel. Steps of 50 mm Multiplex beech, breadth 126 cm. Length of banquette 26 cm. Incl. railing of aluminium, handrails smoothed stainless steel tube  $\varnothing = 42$  mm, cladding stainless steel bracing.

Part # 504734

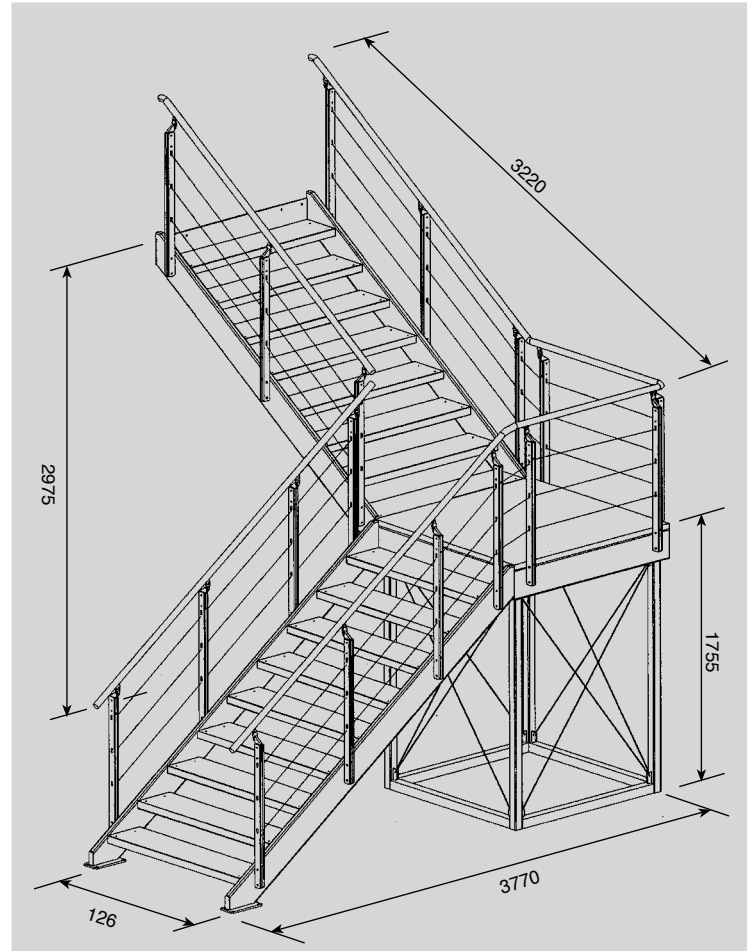

## TR Connection Staircase

Weight: 15,000 kgs.

Part # 504901

# Double Deck: Load Bearing Girder

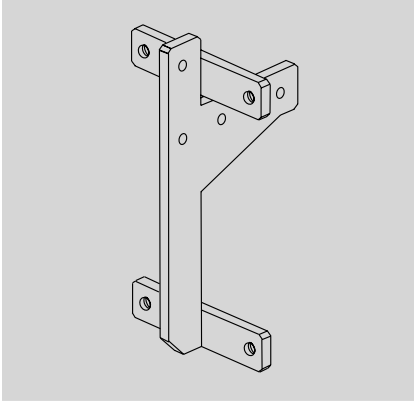

## TR Railing Connection Type 1

Steel, to connect the railing with the main girder.

Weight: 6,800 kgs.

Part # 504460

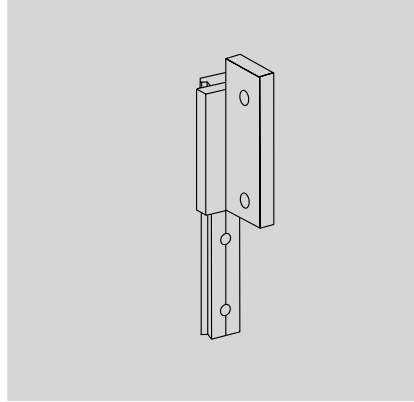

## TR Railing Connection Type 2

Steel, to connect the railing with the Octagonal Support (outside).

Weight: 2,550 kgs.

Part # 504727

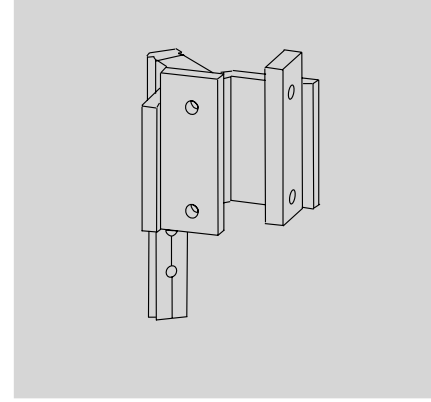

## TR Railing Connection Type 3

Steel, to connect the railing with the Octagonal Support (interior corner).

Weight: 7,500 kgs.

Part # 504549

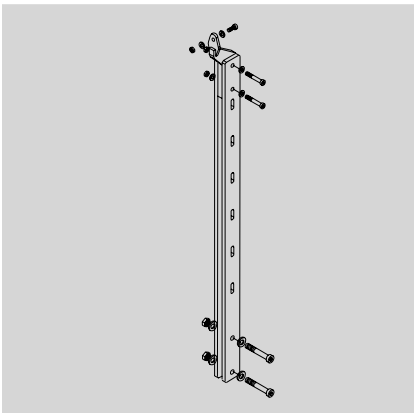

## TR Railing Post

Aluminium. To accept max. 6 cables as filling of railing. To be used for the load bearing girder as well as for the stairs.

Weight: 3,200 kgs.

Part # 505175

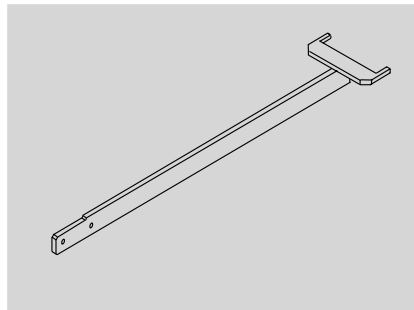

## TR Torsion Prevention for Railing Connection

Steel, to lead away moments from the railing post, if no connecting girders are connected to the main girder. Please see directions of the static calculation.

Weight: 8,840 kgs.

Part # 505336

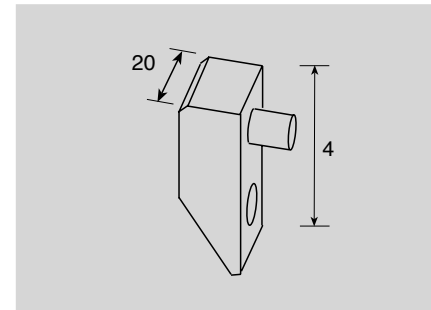

## TR Inclined Connection for Railing Cable

Aluminium, is needed for cable fillings of stairs on the Railing Post.

Weight: 0,013 kgs.

Part # 505171

# Double Deck: Load Bearing Girder

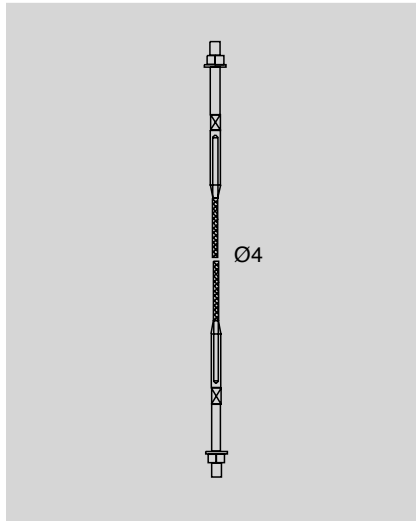

## TR Railing Cable

Aluminium, stainless steel Ø 4 mm, pressed M8 threaded connection.

### Special Length

Part # 504776

#### Length: 1000mm

Weight: 0,102 kgs.

Part # 504775

#### Length: 2000mm

Weight: 3,920 kgs.

Part # 504774

#### Length: 3000mm

Weight: 3,890 kgs.

Part # 504773

#### Length: 4000mm

Weight: 2,130 kgs.

Part # 504772

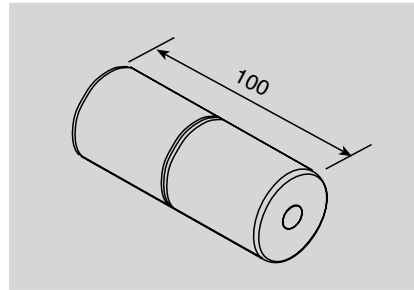

## TR Extension for Handrail

Plastic.

Weight: 0,115 kgs.

Part # 504685

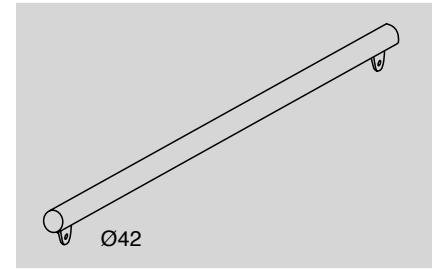

## TR Handrail

Stainless steel tube Ø 42 mm.  
Complete with connection strip and cap.

### Special Length

Part # 504675

#### Length: 1000mm

Weight: 2,000 kgs.

Part # 504671

#### Length: 2000mm

Weight: 4,000 kgs.

Part # 504672

#### Length: 3000mm

Weight: 6,000 kgs.

Part # 504673

#### Length: 4000mm

Weight: 8,000 kgs.

Part # 504674

# Frame Girder

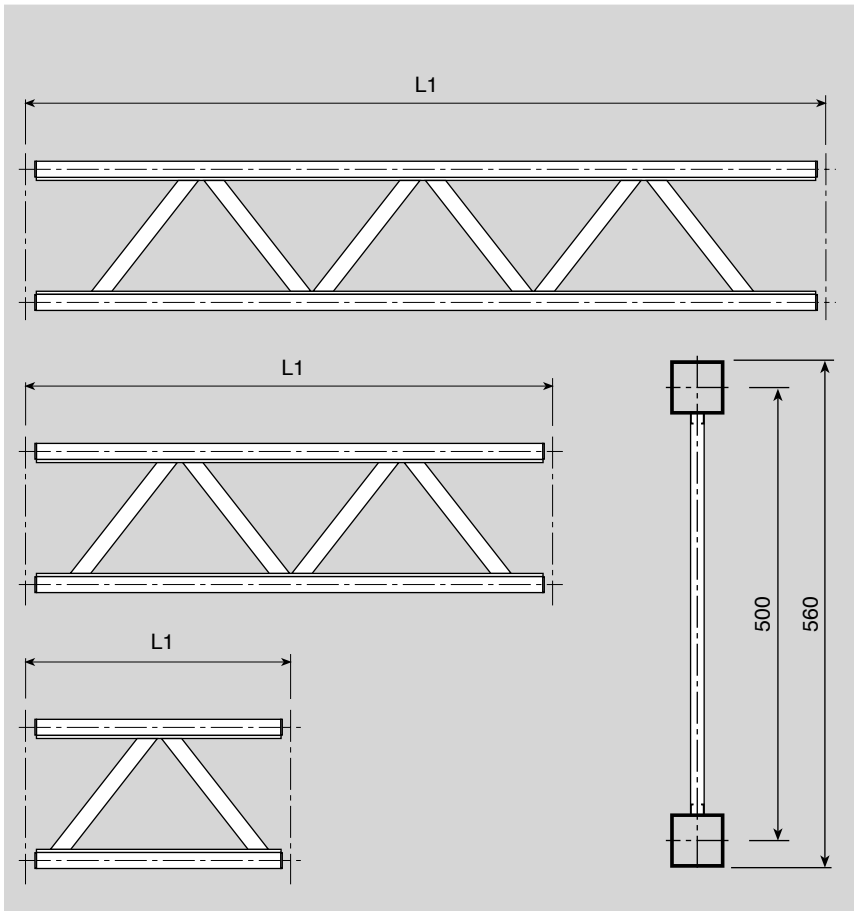

## Girder DUO 60 NK 500

Aluminium, with clamp joints D1 at both ends.

N = groove

K = clamp joint

L1		4/4	4/8	8/8
<b>1000 mm</b>	Weight:	6,330 kgs.	6,130 kgs.	5,940 kgs.
	Part #:	21570 raw 21571 p.c. 505501 E6EV1	21576 raw 21577 p.c. 505500 E6EV1	21564 raw 21565 p.c. 505499 E6EV1
<b>2000 mm</b>	Weight:	11,970 kgs.	11,790 kgs.	11,600 kgs.
	Part #:	21572 raw 21573 p.c. 505504 E6EV1	21578 raw 21579 p.c. 505503 E6EV1	21566 raw 21567 p.c. 505502 E6EV1
<b>3000 mm</b>	Weight:	17,630 kgs.	17,440 kgs.	17,250 kgs.
	Part #:	21574 raw 21575 p.c. 505507 E6EV1	21580 raw 21581 p.c. 505506 E6EV1	21568 raw 21569 p.c. 505505 E6EV1

# Frame Girder

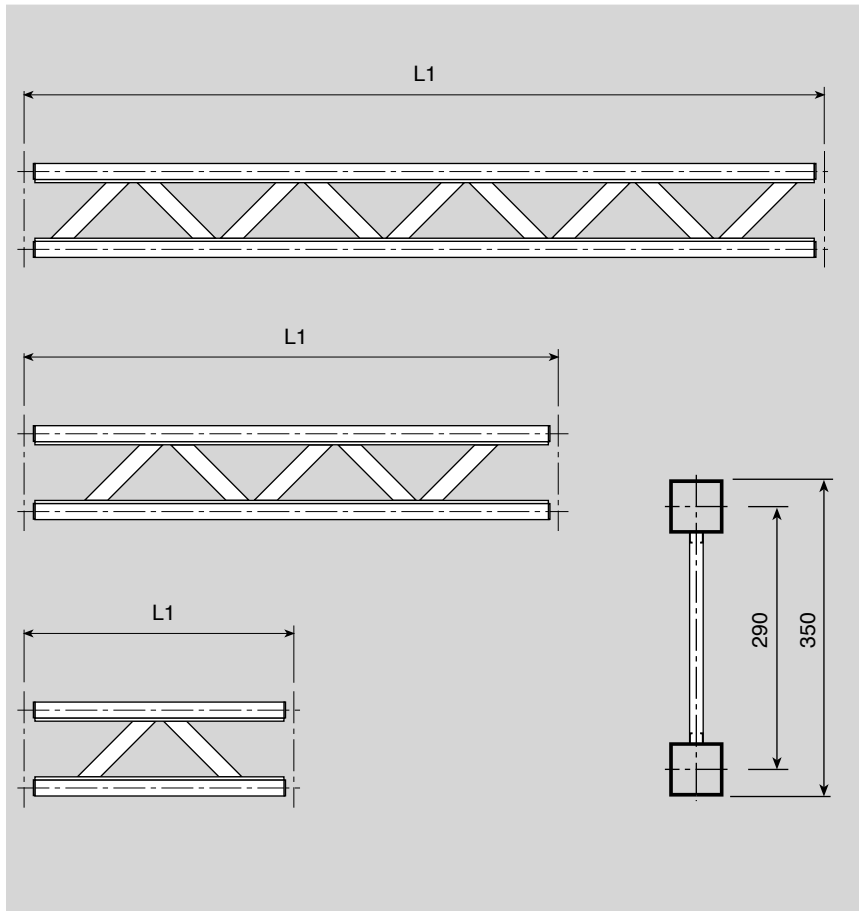

**Frame girder DUO 60 NK 290,**  
Aluminium, with clamp joints D1 at  
both ends.

		<b>4/4</b>	<b>4/8</b>	<b>8/8</b>
<b>1000 mm</b>	Weight:	6,330 kgs.	6,130 kgs.	5,940 kgs.
	Part #:	21682 raw 21681 p.c. 505492 E6EV1	21684 raw 21683 p.c. 505491 E6EV1	21686 raw 21685 p.c. 505490 E6EV1
<b>2000 mm</b>	Weight:	11,970 kgs.	11,790 kgs.	11,600 kgs.
	Part #:	21688 raw 21687 p.c. 505495 E6EV1	21690 raw 21689 p.c. 505494 E6EV1	21692 raw 21691 p.c. 505493 E6EV1
<b>3000 mm</b>	Weight:	17,630 kgs.	17,440 kgs.	17,250 kgs.
	Part #:	21694 raw 21693 p.c. 505498 E6EV1	21696 raw 21695 p.c. 50497 E6EV1	21698 raw 21697 p.c. 505496 E6EV1

# Cable Technique

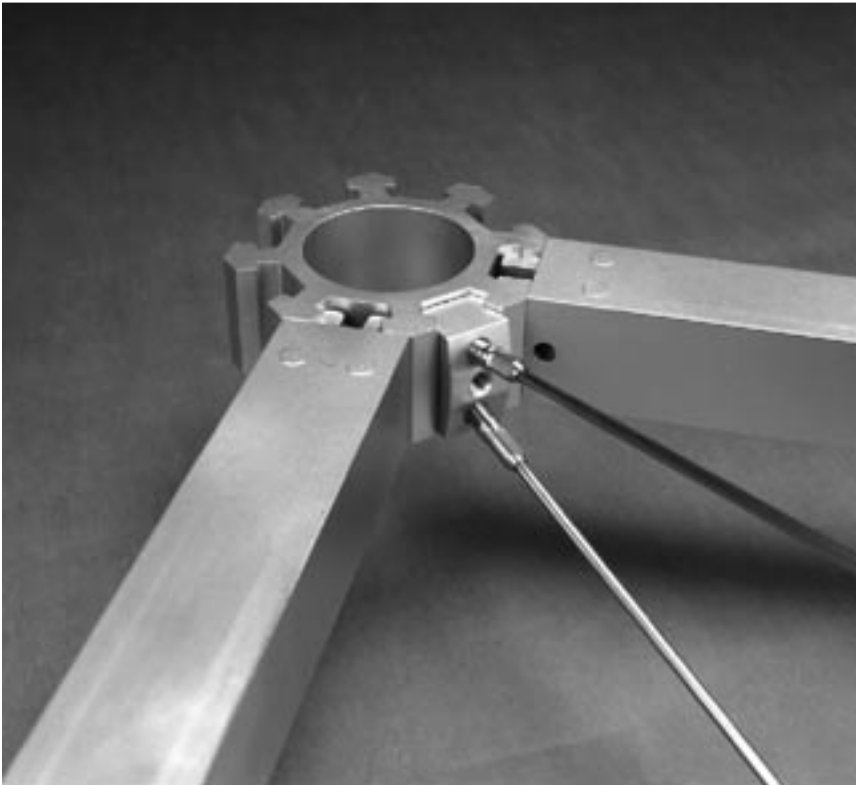

**Cable Node SW 150 Octagonal**  
Aluminium

Weight: 0,120 kgs.

Part # 21668 raw  
21669 p.c.

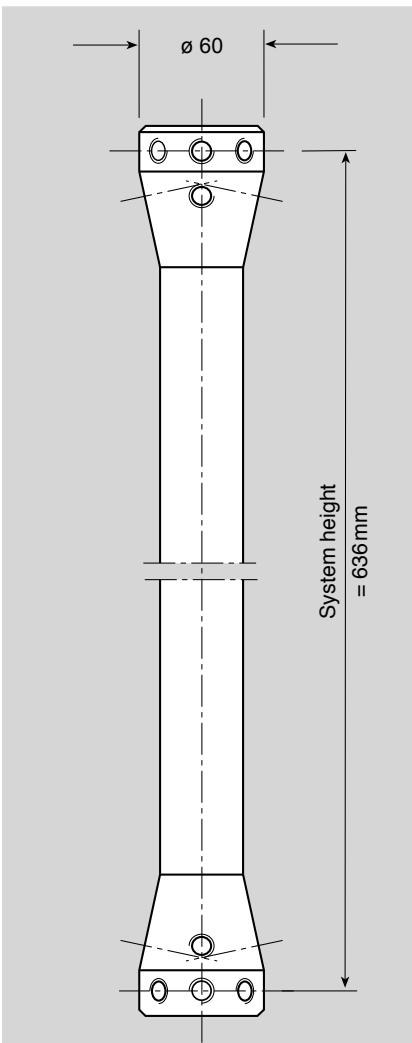

**Cable Node ø 60/40**  
Aluminium

Weight: 0,370 kgs.

Part # 502265 raw  
21671 p.c.

**Tube 520mm ø 40/3**  
Aluminium

Weight: 0,500 kgs.

Part # 21670 p.c.

# Cable Technique

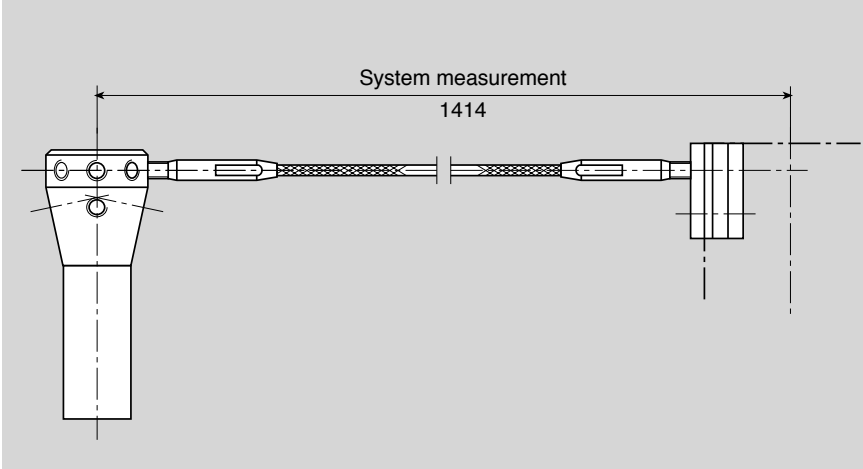

**Tension Cable**

Part # 100165

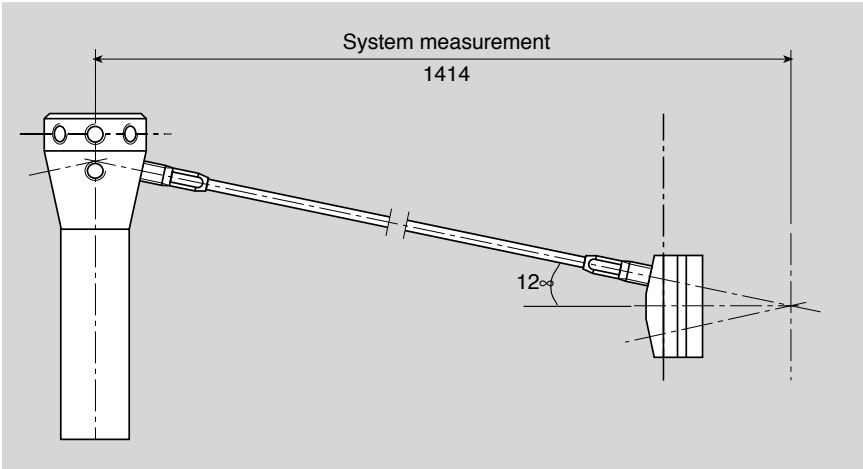

**Tension Rod**

Part # 100194

Central Fixture, 12°, 60 mm, M12, see page 35

**Please note:** The articles on this page are not included in our price list. Price on request (please indicate part # and requested length).

# Central Fixtures

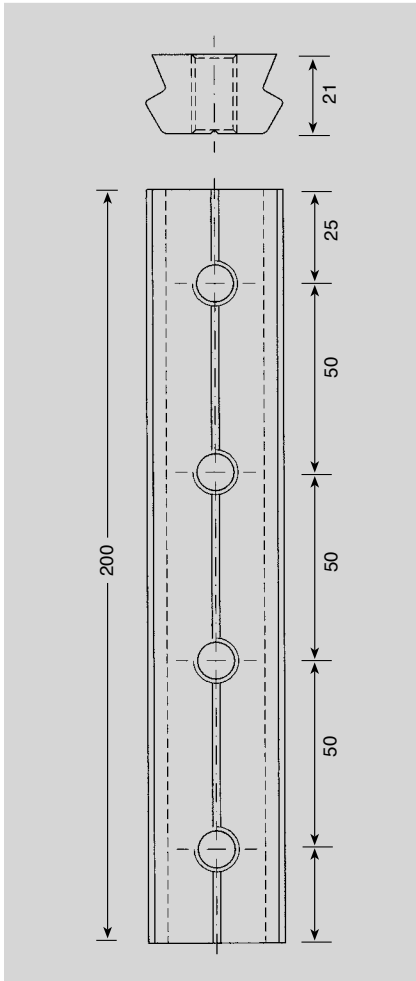

## Central Fixture 21 x 200 mm M12

Aluminium, four boreholes M12, length 200 mm, to connect two 4D supports with four threaded pins DIN 914 M12 x 20 A2.

Weight: 0,322 kgs.

Part # 504365 raw  
504366 p.c.

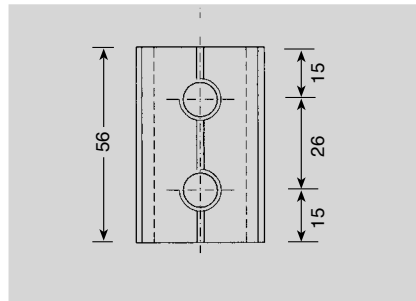

## Central Fixture 21 x 56 mm Spider S

Weight: 0,118 kgs.

Part # 502794 raw  
502954 p.c.

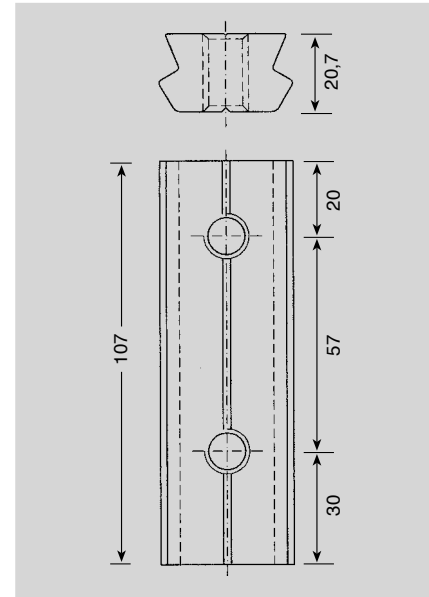
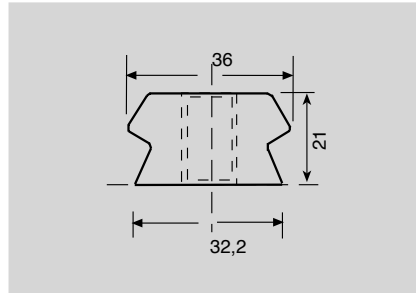

## Central Fixture 21 x 107 mm

Aluminium, two boreholes M12, length 107 mm, to connect two 4D supports. With two threaded pins DIN 914 M12 x 20 A2.

Weight: 0,356 kgs.

Part # 503234 raw  
503174 p.c.

# Central Fixtures

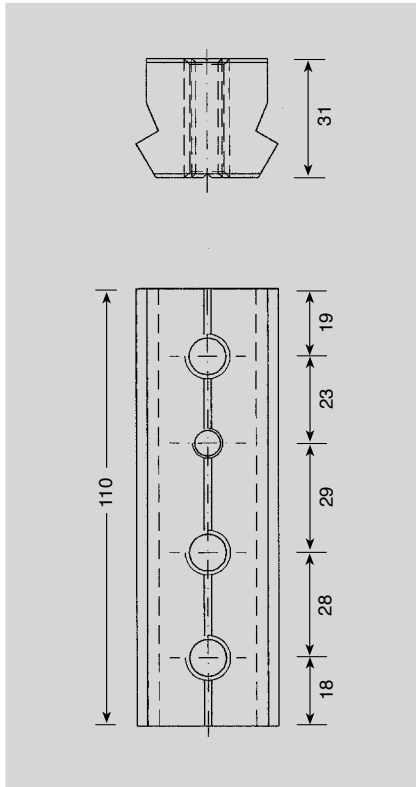

**Central Fixture for Spider Type L1-3**

Weight: 0,118 kgs.

Part # 504304 p.c.  
RAL9006

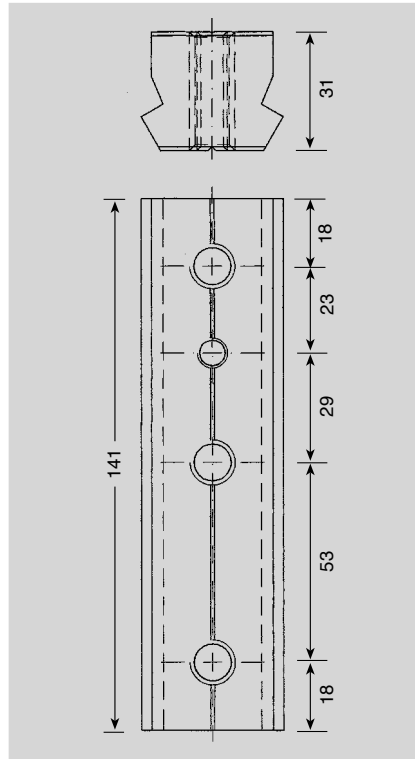

**Central Fixture for Spider Type L4**

Weight: 0,118 kgs.

Part # 504305 p.c.  
RAL9006

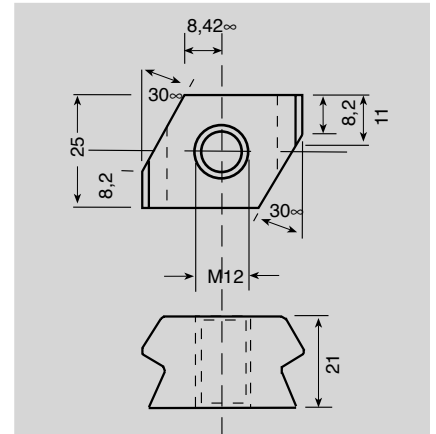

**Central Fixture 25 mm pivotable**

Aluminium, for later installation into the 4D support. To connect light fittings with M12 thread from the Meroform Lighting Catalogue as well as lighter accessories. With one threaded pin DIN 913 M12 x 10 galvanized.

Weight: 0,059 kgs.

Part # 504626 p.c.  
RAL9006

# Central Fixtures

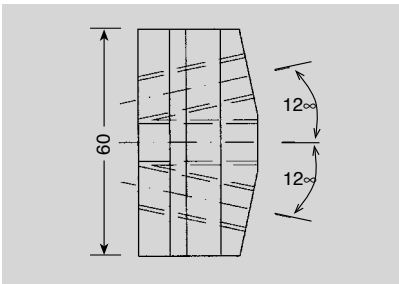
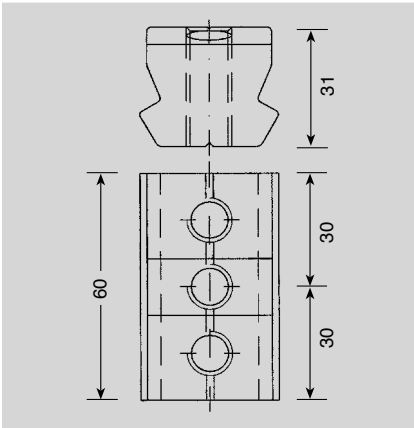

## Central Fixture 12° 60 mm M12

Aluminium, three boreholes M12, length 60 mm, to connect tensile tubes onto the 4D cable node.

Weight: 0,135 kgs.

Part # 502264 raw  
21672 p.c.

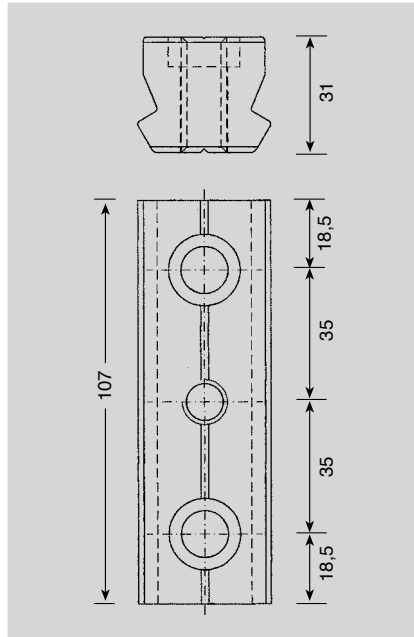

## Central Fixture 107 mm, Conn. M12 cpl.

Weight: 0,118 kgs.

Part # 503609 raw  
503611 p.c.

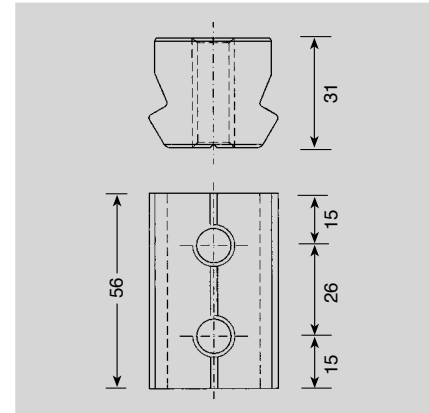

## Central Fixture for Railing Cable M12 AL

Weight: 0,118 kgs.

Part # 10710 roh  
21680 lack.

## Accessories/Tools

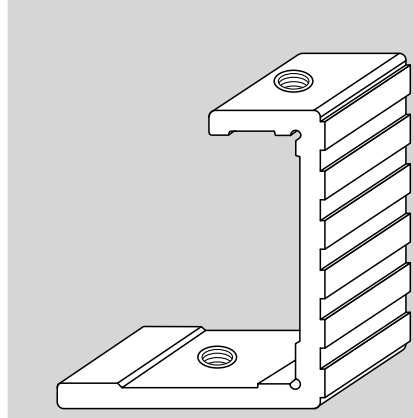

### Connector 4D/M12 aluminium

Weight: 0,090 kgs.

Part # 21780 raw  
21781 p.c.

Example on the left: Connector 4D/M12 with lighting track and light fitting Talus.

For further information on light technique please see our catalogue "Lighting Program – System and Function"

### 4D Tool Set

Plastic case with following contents:  
Wrenches SW5, SW6, SW8 and SW10, nickle plated  
Wrenches SW4 with grip, nickle plated  
Socket for ratchet 3/8" SW6 chrome  
Ratchet wrench 3/8" chrome

Weight: 0,760 kgs.

Part # 21459

### TR Tool Set

Plastic case with following contents:  
Ratchet wrench 3/8" chrome  
Socket for ratchet 3/8" SW6 chrome  
Wrenches SW6, SW8 and SW10 nickle plated  
Nuts 10 mm and 13 mm

Weight: 0,900 kgs.

Part # 504748

### Socket for Ratchet 3/8" SW6 chromed

Weight: 0,030 kgs.

Part # 21463

### Ratchet Wrench 3/8" chrome

Weight: 0,200 kgs.

Part # 21462

### Wrench SW 9/11

Weight: 0,030 kgs.

Part # 21641 black



MeroForm Systems USA is the exclusive importer and fabricator  
in the United States for MERO Exhibit Systems.

MeroForm Systems USA  
429 West Levers Place, Orange, CA 92867  
tel +1.714.974.8544 • fax +1.714.283.2494  
[www.MeroForm.us](http://www.MeroForm.us)